

# **PathSlayer**

**BY MODERN AG**



1655 Louisiana Ave.  
Beaumont, TX 77701  
Phone: 888-404-8908  
[www.modernagproducts.com](http://www.modernagproducts.com)

# INTRODUCTION

The PathSlayer (PS) is a light duty rotary cutter designed to clear overgrown roadways, light land management, and property maintenance.

The PS will easily cut up to 2-3" diameter limbs, brush, saplings, and underbrush. The PathSlayer has 11 positions that allow it to cut vertically, Offset, directly in front (level), or 25°, 35°, & 45° in the vertical and offset positions.

The PathSlayer (PS) attaches to the front of any FEL tractor with a SSQA or JD pin-style attachment system. For additional cost there are adapters available to fit most other applications.

The PathSlayer (PS) weighs just under 580 lbs and the compact under 400 lbs.

In order for the PathSlayer brush cutter to operate to full potential, the tractor must have a hydraulic flow rate of at least 8 GPM, optimal flow is 10 GPM. Hydraulics are linear, 10 GPM equals 100% of the optimal flow, 8 GPM equals 80% of the optimal flow and so on. When purchasing the PathSlayer brush cutter, you will receive a unit equipped with 1/2" male/female coupler inlets.

# INTRODUCTION

This Rotary Cutter is designed with care and built with quality materials by skilled workers. Proper assembly, maintenance, and operating practices, as described in this manual, will help the owner/operator get years of satisfactory service from the machine.

The purpose of this manual is to familiarize, instruct, and train. The Assembly Section instructs the owner/operator in the correct assembly of the Cutter using standard and optional equipment. The Parts Listing section is designed to familiarize the owner/operator with replaceable parts on the Cutter. This section provides exploded assembly drawings of each cutter component illustrating each piece and the corresponding part number.

Careful use and timely service save extensive repairs and costly downtime losses. The Operation and Maintenance Sections of the manual train the owner/operator how to work the Cutter correctly and attend to appropriate maintenance. The Trouble Shooting Guide helps diagnose difficulties with cutter and offers solution to the problems.

Safety is of primary importance to the owner/operator and to the manufacturer. The first section of this manual includes a list of Safety Messages, that, if followed, will help protect the operator and bystanders from injury or death. Many of the Safety Messages will be repeated throughout the manual. The owner/operator/dealer should know these Safety Messages before assembly and be aware of the hazards of operating this rotary cutter during assembly, use, and maintenance. The Safety Alert Symbol combined with a Signal Word, as seen below, is intended to warn the owner/operator of impending hazards and the degree of possible injury faced when operating this machine.



Indicates an imminently hazardous situation that, if not avoided, WILL result in DEATH OR VERY SERIOUS INJURY.



Indicates an imminently hazardous situation that, if not avoided, COULD result in DEATH OR SERIOUS INJURY.



Indicates an imminently hazardous situation that, if not avoided, MAY result in MINOR INJURY.

Identifies special instructions or procedures that, if not strictly observed, could result in damage to, or destruction of the machine, attachments or the environment.

# **SAFETY SECTION**

# SAFETY SECTION

## Overview

Throughout this section you will find various safety precautions and warnings. READ, UNDERSTAND, and FOLLOW ALL safety instructions contained in this section before attempting to operate your machine. This Owner's Manual is a key part of operational safety and must be maintained with the implement at all times.

## To The Operator

KNOW THE EQUIPMENT BEFORE YOU START. Completely read and understand the safety section of this manual before operating this equipment. When operating any piece of equipment the primary responsibility is held by the operator. Do not allow anyone to operate this equipment who has not fully read and understood this manual. Follow instructions at all times while operating the PathSlayer. Failure to follow these instructions could result in serious injury or death.

## Before Using

- THOROUGHLY READ AND UNDERSTAND THE ENTIRE OWNER'S MANUAL BEFORE OPERATION OF YOUR MACHINE.
- Always disconnect hoses prior to making adjustments or servicing.
- Inspect all fasteners prior to use.
- Inspect blades, blade carrier, and bolts for wear.
- Inspect the unit for any damage during transportation.
- For stabilization while operating the PathSlayer, fill rear tires of your tractor with water for use as ballast. (Tractors under 50hp will need additional weight on rear. ie: Box Blade or Rotary Cutter or HR30 hydraulic system.)
- Must be 18 or older to operate the PathSlayer.
- Never raise the PathSlayer above your tractors floorboard height when in the horizontal position.
- Keep body and clothing away from all moving parts.
- DO NOT attempt to repair the PathSlayer while hydraulic hoses are connected.
- Use the machine only for the intended use.
- DO NOT modify the machine in ANY way.
- DO NOT use if any parts are missing or damaged.
- DO NOT operate under the influence of any substance.
- Always use ear, eye, and hand protection when using the cutter.
- DO NOT operate if the motor is in the reversed rotation. (COUNTER CLOCKWISE ONLY!!)
- NEVER operate around people, pets, or live stock (Stay Back 300').
- Complete the pre-use check list before every operation.
- NEVER approach cutter while tractor is running. (Some applications will allow the blades to spin down slowly.)
- NEVER attempt to service and or change positions on uneven surfaces.
- Always remove tractor from gear and apply parking brake before exiting.
- Understand that the blades extend beyond the deck opening.
- DO NOT operate the PathSlayer where there is not sufficient lighting.
- Test ALL controls before you begin.
- DO NOT exceed rated operating flow capacity of hydraulic motor, as the machine may become unstable.
- NEVER leave the machine unattended when in the raised position.

# SAFETY DECALS



- 1
- 2
- 3
- 4
- 5
- 6
- 7
- 8



ITEM	PART NO.	DESCRIPTION	QTY.
.....	490-9000.....	COMPLETE DECAL SHEET.....	1
1	.....	DO NOT ATTACH.....	1
2	.....	LUBRICATE GEARBOX.....	1
3	.....	THROWN OBJECTS.....	1
4	.....	ROTATING BLADES.....	1
5	.....	WARNING TO PREVENT INJURY.....	1
ADDITIONAL SAFETY DECALS BELOW			
6	490-1024.....	KEEP HANDS CLEAR.....	1
7	490-GALVCOAT.....	CAUTION: GALV COATING.....	1
	490-1023.....	MADE IN USA DECAL.....	1
	490-FEMA.....	FEMA MEMBER.....	1
10	490-1501.....	DANGER LOWERING WING.....	1
11	490-PSCCAUTION.....	PATH SLAYER CAUTION.....	1
12	490-2220.....	MODERN DECAL.....	1

# **OPERATION SECTION**

# OPERATION SECTION

## Mounting



## DANGER

When mounting your PathSlayer a crushing hazard exists. **DO NOT** allow anyone to stand between or get near the front of the tractor when attaching.

Always make sure hydraulic hoses are disconnected before attaching or detaching your PathSlayer. Follow these steps at all times while operating the PathSlayer. Failure to follow these instructions could result in serious injury or death.

### Preparing Cutter for Hook-up

1. The PathSlayer should be on a hard flat level surface.
2. Make sure there are no items or debris between the tractor and the PathSlayer.

### Pin Style Loaders (JD)

1. Slowly approach the PathSlayer using the front hydraulic controls to align the front of the boom with the PathSlayer.
2. Place the tractors attachment points under the PathSlayer mounting hooks.
3. Make sure mounting pins are aligned and continue moving the tractor forward until the mounting plate on the PathSlayer is flush against the tractors mounting plate.
4. Place tractor gear selector in park or set park brake, shut engine off, and remove ignition key.
5. Install the locking pins on the back of the mounting plate to lock the PathSlayer into place.  
**NEVER ATTEMPT OPERATE OR MOVE WITHOUT LOCKING THE PATHSLAYER IN PLACE.**
6. Attach the hydraulic pressure and return hoses from the tractor to the PathSlayer.

### Universal Quick Attach (QA)

1. Slowly approach the PathSlayer using the front hydraulic controls to align the front of the boom with the PathSlayer.
2. Place the tractors attachment points under the PathSlayer mounting plate.
3. Continue moving the tractor forward until the mounting pins lock into place and the PathSlayer is flush against the tractors mounting plate.
4. Place tractor gear selector in park or set park brake, shut engine off, and remove ignition key.
5. On the tractor, push the locking arms down until they have locked the PathSlayer in place.  
**NEVER ATTEMPT OPERATE OR MOVE WITHOUT LOCKING THE PATHSLAYER IN PLACE.**
6. Attach the hydraulic pressure and return hoses from the tractor to the PathSlayer.
7. ***IMPORTANT NOTICE:*** On some tractor applications equipped with the QA system you may need to trim the top hooks of the PathSlayer to ensure full operational clearance of your tractors boom.

# OPERATION SECTION

## Mounting

**Figure 1**

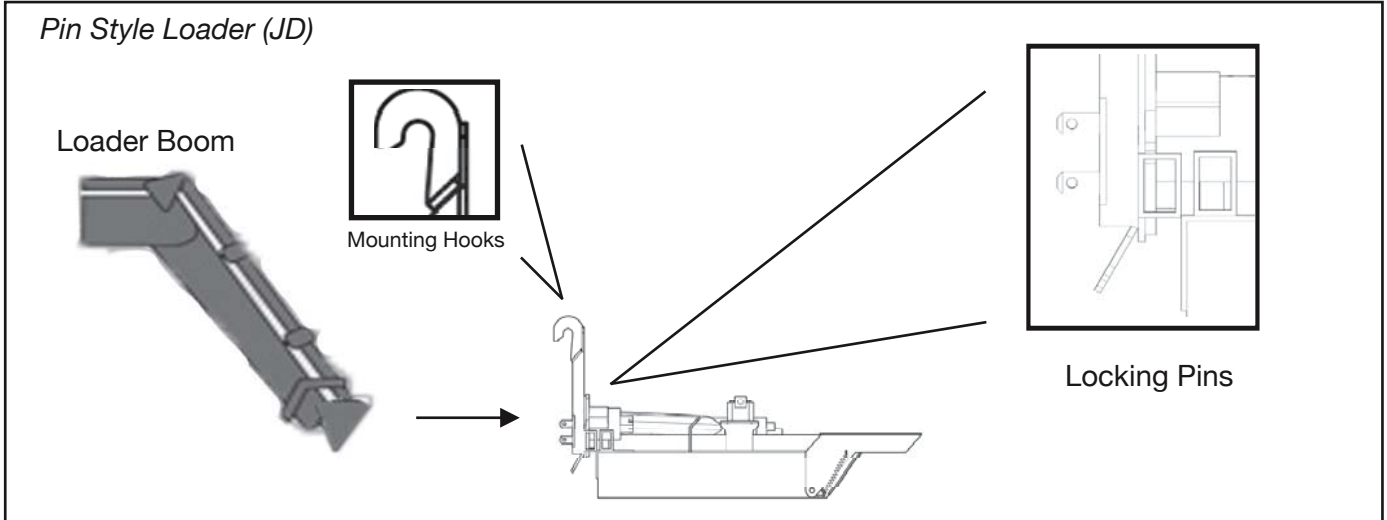

**Figure 2**

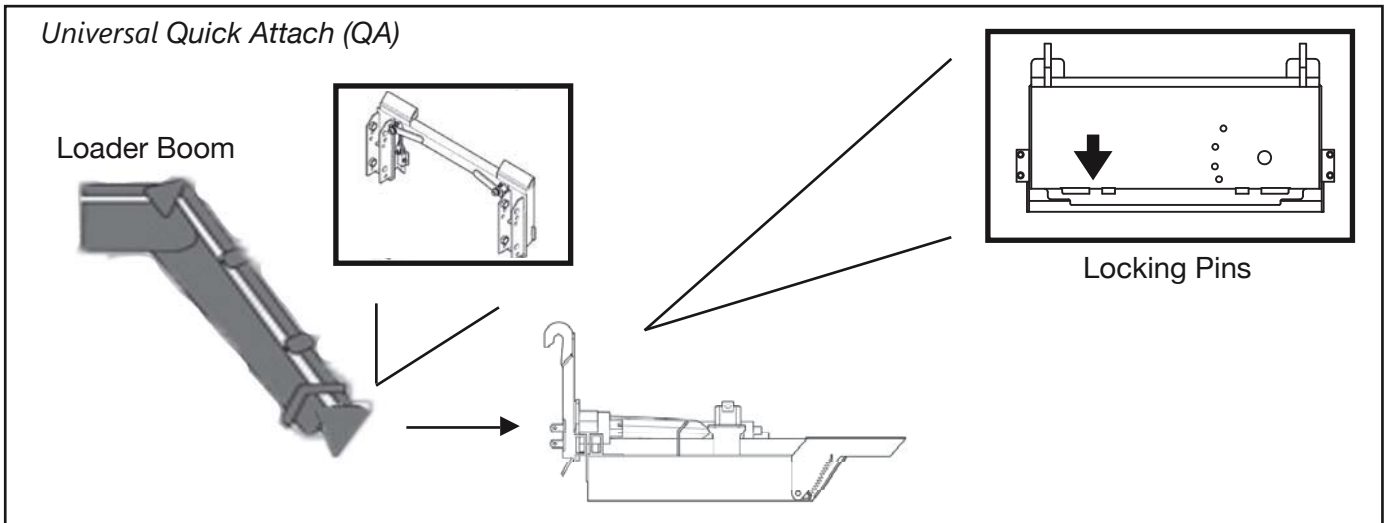

# OPERATION SECTION

## Tractor Requirements

In addition to correct hydraulic flow and horsepower, the tractor must also be properly equipped with operator protection including a Roll Over Protection Structure or (ROPS).

- Minimum hydraulic flow is 9GPM
- Maximum flow is 21 GPM with standard motor.
- Certified Roll Over Protection Structure (ROPS)
- Rear Remotes

## Cutting Operation

1. Before attempting to operate, read and understand the owners manual.
2. Activate the auxiliary hydraulics with engine at idle.
3. Gradually increase engine speed.
4. Allow motor to spin up to full speed.
5. Be sure that the PathSlayer is operating correctly *ie: No vibration and proper rotation.*
6. Begin forward travel while maintaining blade rotation and avoiding blade stall.

## CAUTION

- Never raise and operate the PathSlayer to the point where you can view the blades or underside of the cutter.
- Always make sure you can see while cutting.
- Never operate in populated areas where thrown objects could injure persons or damage property.
- Never operate the PathSlayer under the influence of any substances.
- Never leave the PathSlayer unattended when it is in any of its raised -positions.
- Never attempt to cut while the tractor is in the reverse gear.

## Cutting Large Brush

The PathSlayer is capable of cutting limbs and brush up to 3" in diameter. When using the PathSlayer to cut large brush or limbs slowly approach the area with the PathSlayer approximately 1-2 feet off of the ground. Make sure the motor on the PathSlayer is spinning at full speed. The blades extend roughly 2-3" beyond the front opening of the PathSlayer and as the PathSlayer approaches the brush continue to drive the tractor forward into the target area until the brush has been cut.

## Cutting Grass or vegetation

The PathSlayer is designed to cut all types of grass and light vegetation around ponds, road sides, and ditches. To cut grass or light vegetation place the PathSlayer approximately 1-2 inches above the ground and slowly drive forward while keeping attention to the cutting path to make sure no foreign objects are obstructing the path of the PathSlayer.

## Overheating

The motor on the PathSlayer is not designed to withstand continuous stalling. If the motor is continuously stalled while operating you may cause the unit to overheat. Avoid stalling the unit as much as possible.

## OPERATION SECTION

### **TroubleShooting**

**Jammed or stalled:** If while cutting, you stall or jam the unit you need to follow these steps to safely return the unit back to its functioning standard.

- 1) Return the tractor back to idle speed
- 2) Disengage axillary hydraulics
- 3) Park the tractor on a level surface
- 4) Place the tractor in park gear
- 5) Set parking break
- 6) Shut engine off
- 7) Wait for all motion to come to a complete stop
- 8) Remove ignition key
- 9) Disconnect all hydraulic hoses from the PathSlayer
- 10) Remove any tangled debris from the bottom of the unit

**Restarting blade rotation:** Once you have cleared any tangled debris that may have hindered the operation of the PathSlayer you will need to return the unit to its functioning standard.

- 1) Reconnect hydraulic hoses going to the PathSlayer Turn tractor engine to the ON position
- 2) Slowly engage auxiliary hydraulics
- 3) Idle tractor up to proper RPM (PTO speed)
- 4) Spin the PathSlayer back up to full speed

**Repeated Stalling of Rotary Motor:** If your PathSlayer continues to stall repeatedly, review and inspect all components. If the components have been inspected and reviewed and no issues are found, then review and inspect the size/density of the material being cut to make sure it fits the parameters of the PathSlayer's capabilities.

# OPERATION SECTION

## **Safety**

It is the operators main responsibility to ensure that the PathSlayer is being operated as safe as possible at all times. Before attempting to operate the PathSlayer, make sure you have read the owners manual. READ, UNDERSTAND, and FOLLOW all safety directions associated with the PathSlayer. •

Follow instructions at all times while operating the PathSlayer. Failure to follow these instructions could result in serious injury or death. •

- WEAR SAFETY GLASSES, safety shoes, hard hat, hearing protection and gloves when operating or repairing equipment. •
- WEAR appropriate breathing respirator when operating in dusty conditions to avoid respiratory diseases. •
- DO NOT wear loose clothing or jewelry while near rotating or moving parts, this could cause an entanglement injury. •
- DO NOT operate any equipment while under the influence of any substance.
- DO NOT allow anyone to operate equipment under the influence of any substance.
- STAY ALERT, prolonged operation can cause lack of attention, STOP and REST.
- DO NOT allow anyone to stand between or get near the front of the tractor when attaching. •
- NEVER attempt to repair or change positions on the PathSlayer while hydraulic hoses are connected. (Refer to page 15 for correct troubleshooting procedures) •
- DO NOT operate if the motor is in the reversed rotation. (COUNTER CLOCKWISE ONLY!!)
- NEVER operate around people, pets, or live stock (Stay Back 300').
- Complete the pre-use check list before every operation. (page 13)
- NEVER approach cutter while tractor is running. (Some applications will allow the blades to spin down slowly.) •
- NEVER attempt to service the PathSlayer while on uneven surfaces.
- NEVER attempt to change positions on the PathSlayer while on uneven surfaces.
- Always remove tractor from gear and apply parking brake before exiting.
- Understand that the blades extend 2-3 inches beyond the deck opening.
- DO NOT operate the PathSlayer where there is not sufficient lighting.
- Test ALL controls before you begin.
- DO NOT exceed rated operating flow capacity of hydraulic motor, as the machine may become unstable. •
- NEVER leave the machine unattended when in the raised position.
- DO NOT operate the PathSlayer on a tractor not equipped with a ROPS.
- DO NOT operate the tractor without the ROPS in the upright position.
- ALWAYS wear seatbelt.
- ALWAYS pay attention to cutting path.
- DO NOT operate the PathSlayer in populated areas.

# OPERATION SECTION

## PRE USE CHECK-LIST

PathSlayer

### Check-list

	Cutting Deck is free of objects.
	Unit is properly attached to the tractor and locked in.
	No degradation of metal or welds.
	All fasteners are secure. (pins, nuts, bolts, washers)
	Blade carrier is secure.
	Blades and blade fasteners are secure.
	All warning labels are in place.
	Make sure radiator is clear of debris.
	Hydraulic system connected correctly.
	Hydraulic fluid levels normal.
	Inspect blades, blade carrier, and bolts for wear.
	Hydraulic Hoses (Not Kinked/Tight Connections)
	Motor is properly connected.
	Blade carrier bolts properly torqued/cotter pin in place.
	Spindle and motor bolts properly torqued.
	Correct blade rotation (counter clockwise)
	PathSlayer pivot point properly greased.
	Tractor power brake fluid level and condition.
	No oil leaks.
	Tractor ROPS is in good condition.
	ROPS is in the raised position.
	Tractor engine oil level and condition.
	Tractor engine coolant level and condition.
	Sufficient lubrication at all lube points.
	Tractor lights are clean and functional.
	Tractor power steering fluid level and condition.

# OPERATION SECTION - ADJUSTMENTS

## Transition Process

Your PathSlayer is capable of cutting in 11 different positions. Once you have successfully connected the PathSlayer to your tractor and familiarized yourself with all of its components, it is time to begin learning the transition process. This section will go over how to properly transition your PathSlayer into each of those positions.

## Before you get started

- Make sure tractor gear selector is in park or set park brake.
- Make sure the engine is off.
- Make sure ignition key is removed.
- Make sure the tractor is parked on a level surface.
- Make sure all hydraulic hoses are disconnected from the PathSlayer.

## Positions

1. Home (Directly in front) [A]
2. Offset (0 degrees level) [B]
3. Offset (25 degrees lowered)
4. Offset (35 degrees lowered) [C]
5. Offset (25 degrees raised)
6. Offset (35 degrees raised)
7. Vertical (90 degrees upright) [D]
8. Vertical (25 degrees lowered)
9. Vertical (35 degrees lowered) [E]
10. Vertical (25 degrees raised)
11. Vertical (35 degrees raised)

**A**

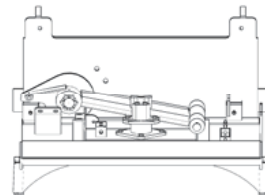

**B**

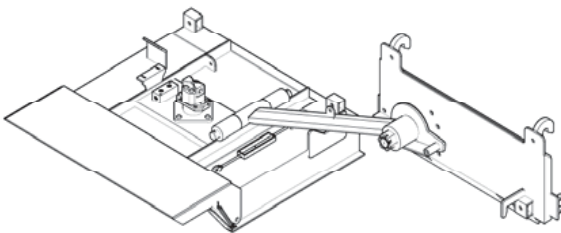

**C**

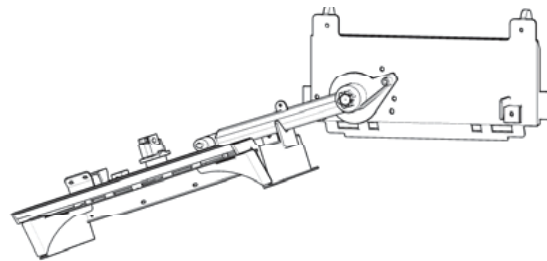

**D**

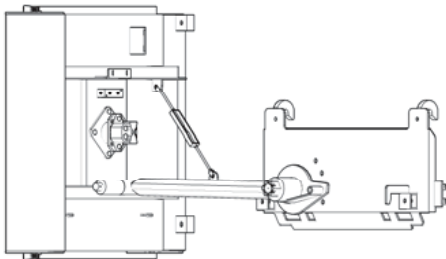

**E**

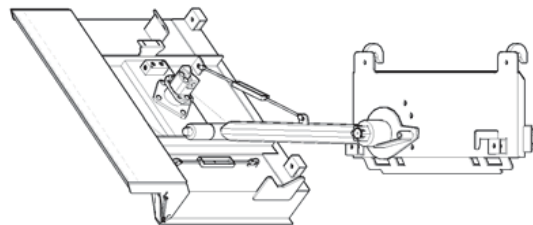

## OPERATION SECTION - ADJUSTMENTS

### **Directly in Front (Home)**

The directly in front or "home" position is the position that your PathSlayer is delivered in. (Refer to Figure 1 for visual reference) The PathSlayer should ALWAYS be placed in the home position when transporting, storing or mounting/dismounting from the tractor.

*Figure 1*

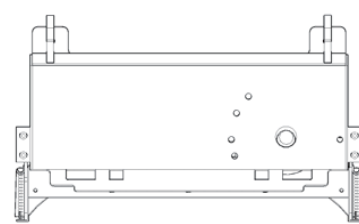
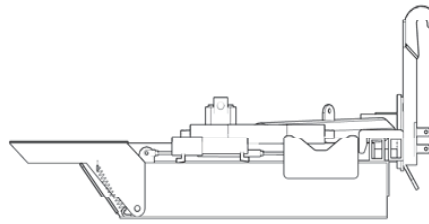
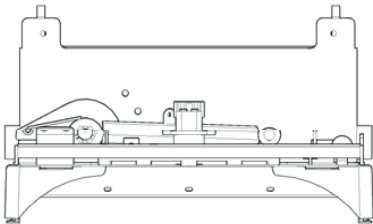
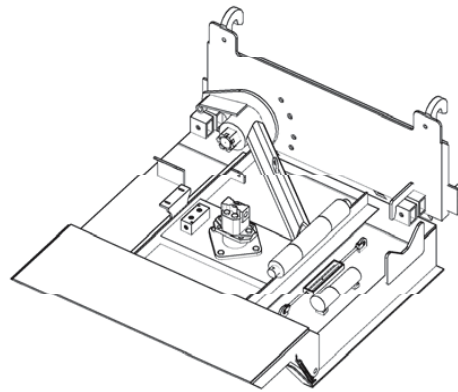
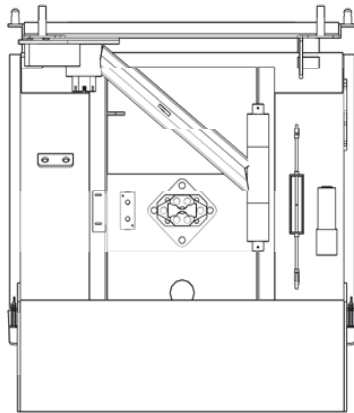

## OPERATION SECTION - ADJUSTMENTS

### Offset

This position allows the PathSlayer to extend from directly in front of the tractor to horizontally beside the tractor. The offset position is the recommended position for cutting around ponds, near ditches, and along roadsides. On this page you will be shown how to correctly move the PathSlayer from the home position to the offset position.

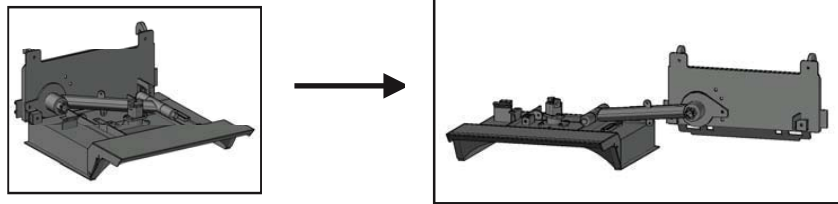

### Instructions



#### CAUTION

While changing positions on the PathSlayer there is a crushing hazard. DO NOT place fingers, hands, or body between the PathSlayer and tractor while changing positions.



1. Make sure all hydraulic hoses are disconnected from the PathSlayer.
2. Lift the boom of the tractor until the PathSlayer has enough clearance between the ground to point directly down. **STOP before going any further make sure you have read and completed the "Before you get started" section on page 14.**
3. With PathSlayer pointing directly down, pull both pull pins on the left and right sides of the PathSlayer.
4. Facing the front of the tractor push the right side of the PathSlayer toward the front of the tractor. This will cause the PathSlayer to rotate around the main pivot point.
5. Facing the front of the tractor walk to the left side and push the left corner of the PathSlayer until it is parallel with the front of the tractor.
6. From the left side pull the PathSlayer until it extends completely out from the tractor.
7. Once the PathSlayer has been completely extended, insert the position adjustment pin, and lock it into the desired position hole.
8. On the backside of the mounting plate the position adjustment pin will protrude roughly 1/2". Place the keeper pin that you previously removed through the exposed hole of the position adjustment pin.
9. Reinstall both pull pins on the deck of the PathSlayer.
10. Reinstall both hydraulic Lines on the PathSlayer.

## OPERATION SECTION - ADJUSTMENTS

### Returning Back to Home Position (From Offset)

When you are finished cutting with the PathSlayer in any of its positions, it is very important that you return it back to the home position. The PathSlayer is not designed to be transported or stored in any other position except the home position. On this page you will be shown how to correctly move the PathSlayer from the offset position back to the home position.

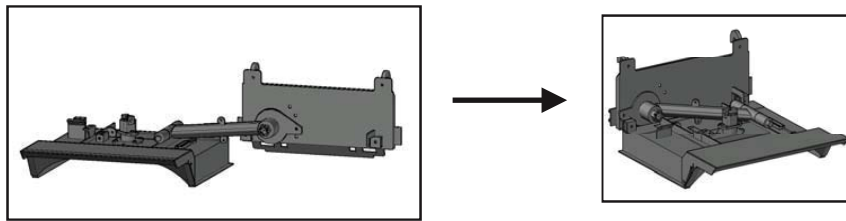

### Instructions



#### CAUTION

While changing positions on the PathSlayer there is a crushing hazard. DO NOT place fingers, hands, or body between the PathSlayer and tractor while changing positions.



1. Make sure all hydraulic hoses are disconnected from the PathSlayer.
2. Lift the boom of the tractor until the PathSlayer has enough clearance between the ground to point directly down. **STOP before going any further make sure you have read and completed the "Before you get started" section on page 14.**
3. With PathSlayer pointing directly down, on the backside of the mounting plate the position adjustment pin will protrude roughly 1/2". Remove the keeper pin from the position adjustment pin.
4. Pull the position adjustment pin until you see the small keeper pin hole.
5. Place the keeper pin into the hole on the position adjustment pin. This allows the PathSlayer to rotate freely around the main pivot point.
6. Pivot the PathSlayer until the deck is perpendicular with the mounting plate.
7. Facing the tractor push the PathSlayer towards the tractor until it pivots parallel with the front of the tractor.
8. Facing the tractor go to the left side of the PathSlayer and while keeping the deck of the PathSlayer parallel with the front of the tractor, push the deck of the PathSlayer until it reaches the home position.
9. Reinstall both pull pins on the deck of the PathSlayer.
10. Reinstall both hydraulic Lines on the PathSlayer.

## OPERATION SECTION - ADJUSTMENTS

### Vertical

This position allows the PathSlayer to extend from directly in front of the tractor to Vertically beside the tractor. The vertical position is the recommended position for trimming over hanging tree limbs, brush along shooting lanes, and light vegetation along overgrown roads or pathways. On this page you will be shown how to correctly move the PathSlayer from the home position to the vertical position.

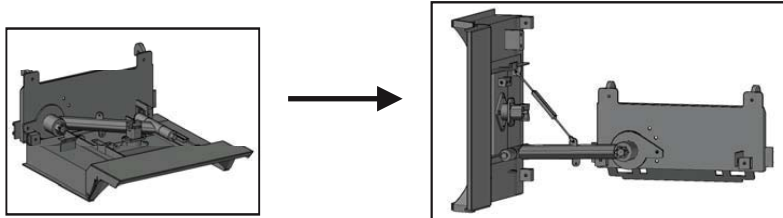

### Instructions



#### CAUTION

While changing positions on the PathSlayer there is a crushing hazard. DO NOT place fingers, hands, or body between the PathSlayer and tractor while changing positions.



1. Make sure all hydraulic hoses are disconnected from the PathSlayer.
2. Lift the boom of the tractor until the PathSlayer has enough clearance between the ground to point directly down. **STOP before going any further make sure you have read and completed the "Before you get started" section on page 14.**
3. With PathSlayer pointing directly down, pull both pull pins on the left and right sides of the PathSlayer.
4. Facing the front of the tractor push the right side of the PathSlayer toward the front of the tractor. This will cause the PathSlayer to rotate around the main pivot point.
5. Facing the front of the tractor walk to the left side and push the left corner of the PathSlayer until it is parallel with the front of the tractor.
6. From the left side pull the PathSlayer until it extends completely out from the tractor.
7. Once the PathSlayer has been completely extended, insert the position adjustment pin, and lock it into the desired position hole.
8. On the backside of the mounting plate the position adjustment pin will protrude roughly 1/2". Place the keeper pin that you previously removed through the exposed hole of the position adjustment pin.
9. Remove the keeper pin from the turnbuckle
10. Pivot the PathSlayer until the deck is perpendicular with the mounting plate.
11. Reattach the turnbuckle to the top mounting bracket and lock it in with the keeper pin you previously removed.
12. Reinstall both hydraulic Lines on the PathSlayer.

## OPERATION SECTION - ADJUSTMENTS

### Returning Back to Home Position (From Vertical)

When you are finished cutting with the PathSlayer in any of its positions, it is very important that you return it back to the home position. The PathSlayer is not designed to be transported or stored in any other position except the home position. On this page you will be shown how to correctly move the PathSlayer from the vertical position back to the home position.

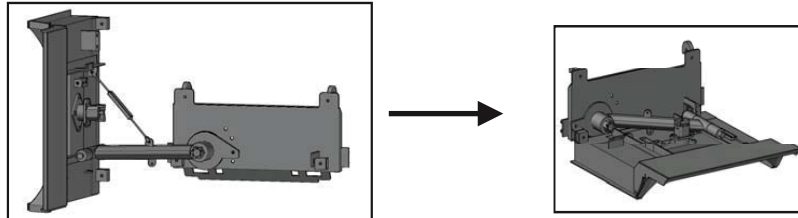

### Instructions



#### CAUTION

While changing positions on the PathSlayer there is a crushing hazard. DO NOT place fingers, hands, or body between the PathSlayer and tractor while changing positions.



1. Make sure all hydraulic hoses are disconnected from the PathSlayer.
2. Lift the boom of the tractor until the PathSlayer has enough clearance between the ground to point directly down. **STOP before going any further make sure you have read and completed the "Before you get started" section on page 14.**
3. With PathSlayer pointed directly down, remove the keeper pin from the turnbuckle.
4. Pivot the PathSlayer until the deck is perpendicular with the mounting plate.
5. Reattach the turnbuckle to the bottom mounting bracket and lock it in with the keeper pin you previously removed.
6. On the backside of the mounting plate the position adjustment pin will protrude roughly 1/2". Remove the keeper pin from the position adjustment pin.
7. Pull the position adjustment pin until you see the small keeper pin hole.
8. Place the keeper pin into the hole on the position adjustment pin. This allows the PathSlayer to rotate freely around the main pivot point.
9. Pivot the PathSlayer until the deck is perpendicular with the mounting plate.
10. Facing the tractor push the PathSlayer towards the tractor until it pivots parallel with the front of the tractor.
11. Facing the tractor go to the left side of the PathSlayer and while keeping the deck of the PathSlayer parallel with the front of the tractor, push the deck of the until it reaches the home position.
12. Reinstall both pull pins on the deck of the PathSlayer.
13. Reinstall both hydraulic lines on the PathSlayer.

## OPERATION SECTION - COMPONENTS

### Cutting Deck (01)

The cutting deck on the PathSlayer (PS) is the main platform that supports the motor, blades, and most adjustment components on the PS. When in the home position, all adjustment components are mounted on top of the deck including the gearbox plate (03), turnbuckle (04), adjustment hinge (05), main adjustment arm (06), main arm support (09), and the tower locks (13). Mounted in the center of the deck there is a 0.188" thick plate with a 10 x 22 inch opening, this is where the motor mounts through the deck. This is called the gearbox plate (03). Closely surrounding the center hole are four mounting holes, these are for the spindle to be mounted to the deck of the PS. Approximately 9 inches on either side of the motor are two 90 degree angle iron deck supports (A&B) that run front to back of the PS and are approximately 24 inches in length. (Facing the unit) The left deck support (A) is supplied with a bracket (C) for the turnbuckle (04) to connect once the PS is in the vertical and offset positions. The right deck support (B) is mounted to the Main Adjustment Hinge (05) which allows the PS to pivot into the vertical and offset positions while maintaining attachment to the mounting plate (02).

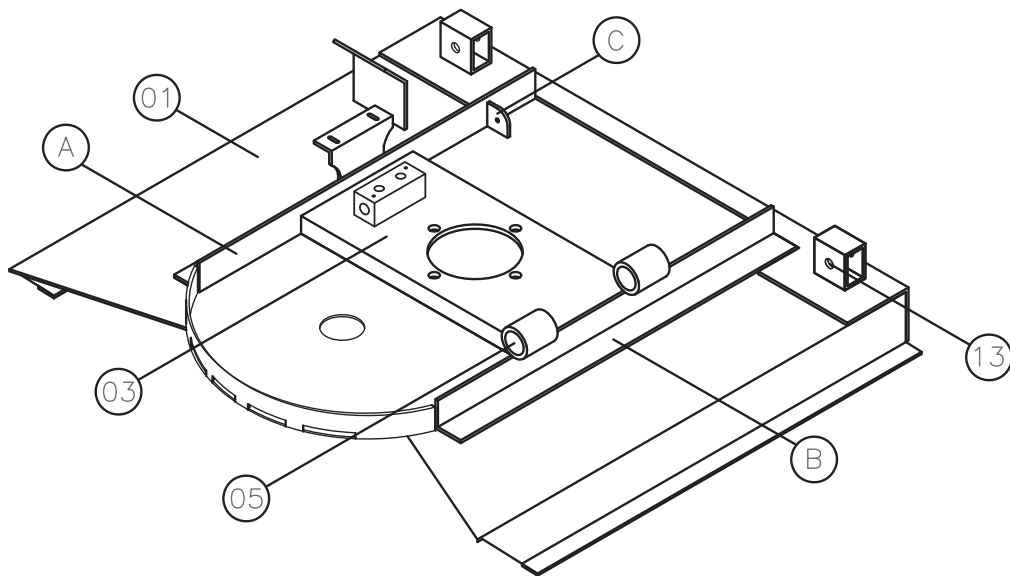

# OPERATION SECTION - COMPONENTS

## Cutting Deck (01) Con't

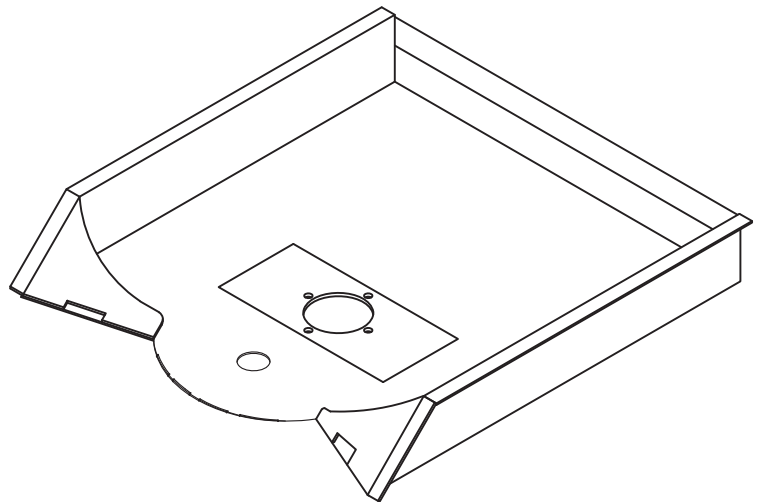
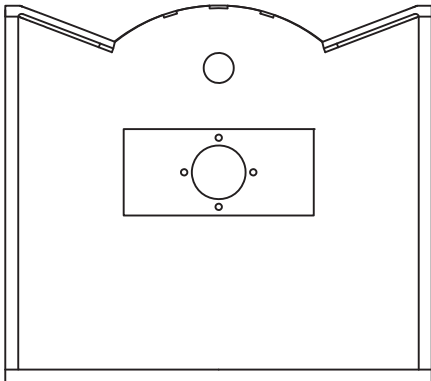
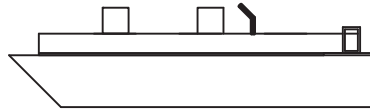
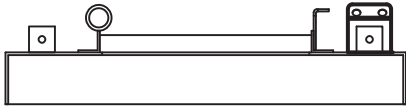
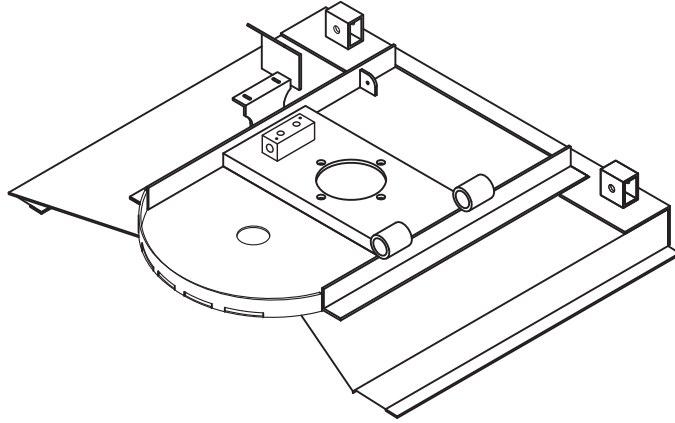
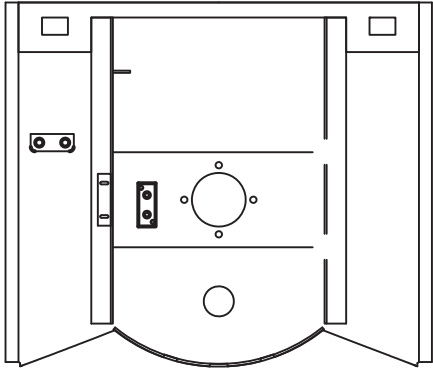

## OPERATION SECTION - COMPONENTS

### Mounting Plate (02)

The Mounting Plate (02) mounts vertically to the rear of the cutting deck (01) this allows the Mounting Plate (02) to act as the main support system for the PS. (Facing the unit) Offset to the left side of the Mounting Plate (02) is a roughly 3 inch mast boss, this attaches the Main Adjustment Arm (06), turnbuckle (04), Main Adjustment Hinge (05), Main Arm Support (10), to the Cutting Deck (01) and operates as the Main Pivot Point (07). Surrounding this are 5 Position Adjustment (18) holes. By using the the Main Pivot Point (07) and the multiple Position Adjustments (18) it allows the the PS to transition up to 180 degrees to the vertical and offset positions. (Facing the unit ) Near the bottom right corner of the Mounting Plate (02) a single Lock Bracket (09) is attached to lock the Cutting Deck (01) via Tower Locks (13) to the Mounting Plate (02) when in the home position.

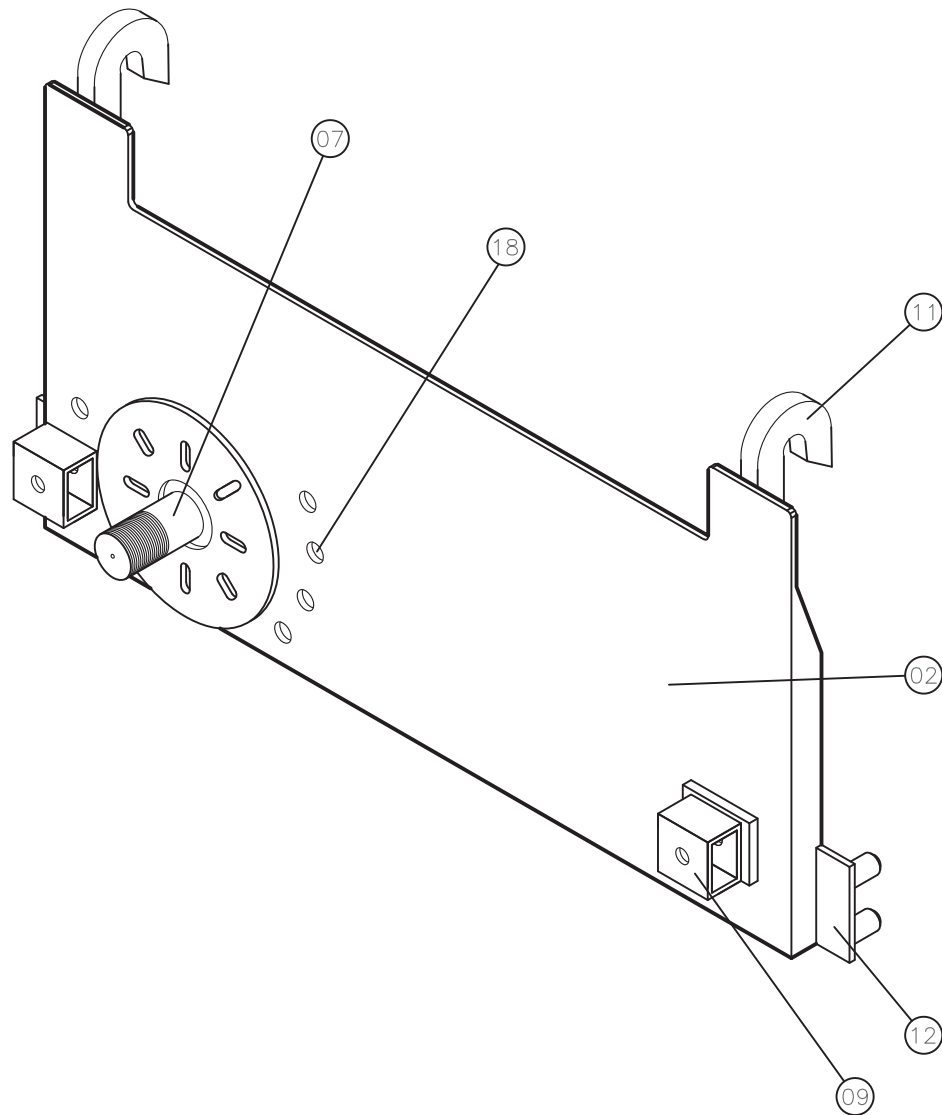

## OPERATION SECTION - COMPONENTS

### Mounting Plate (02) Con't

The Mounting Plate (02) is the main connection between the PathSlayer and the tractor. The PS supports two types of mounting systems, SSQA and Pin-Style. The SSQA is mounted by attaching a SSQA plate onto the backside of the PS Mounting Plate (02) using the SSQA Top (19) and Bottom (20) connection points. The Pin-Style is mounted by attaching the Mounting Hooks (11) located on the top left and right sides of the PS. Once the Mounting Hooks (11) are attached, the Mounting Pins (12) located on the lower left and right sides of the PS will then lock the PS to the Pin-Style loader.

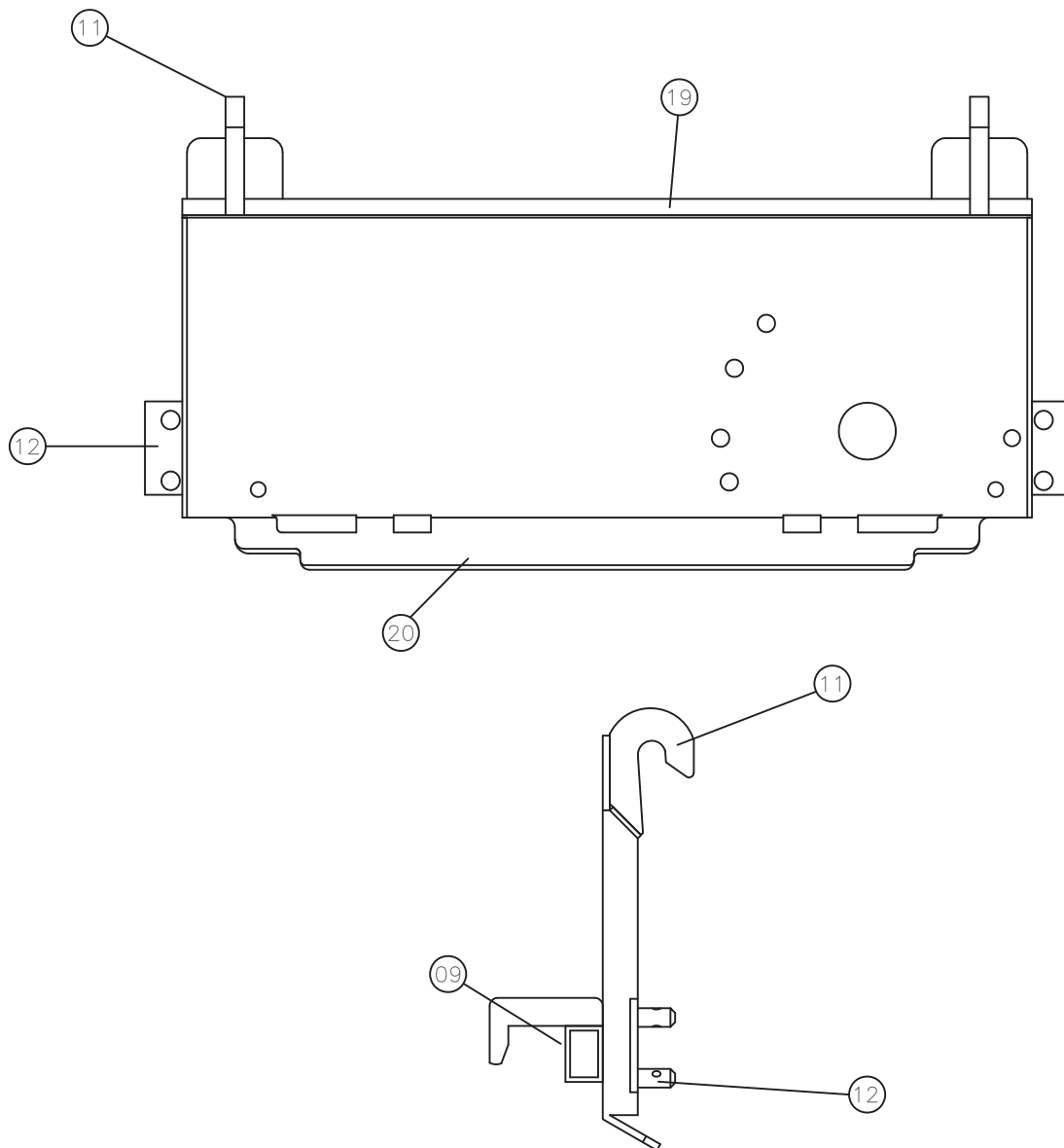

## OPERATION SECTION - COMPONENTS

### Main Adjustment Arm (06)

The Main Adjustment Arm (06) is the main connection between the Mounting Plate (02) and the Cutting Deck (01). This connection is made by attaching the Main Adjustment Arm (06) to the Mounting Plate (02) via the Main Pivot Point (07) and attaching the Cutting Deck (01) to the Main Adjustment Arm (06) via the Main Adjustment Hinge (05). This allows the PS Cutting Deck (01) to move 180 degrees from directly in front of the tractor to the vertical and offset positions while staying attached to the loader. Once in any of the positions the Main Adjustment Arm (06) is supported by the Main Support Arm (10) to keep the PS's structure stable while in transition or operation. Extending forward roughly 24 inches from the Main Adjustment Arm (06) is the Main Adjustment Hinge (05). This allows the Cutting Deck (01) to move 180 degrees around the Main Adjustment Arm (06) from the horizontal cutting positions to the vertical cutting positions. (Facing the unit) There are two Lock Brackets (09) attached to the left and right sides of the Main Adjustment Arm (06), the Lock Brackets (09) allow the Main Adjustment Arm (06) to lock to the Cutting Deck (01) via the Tower Locks (13) when in the home position.

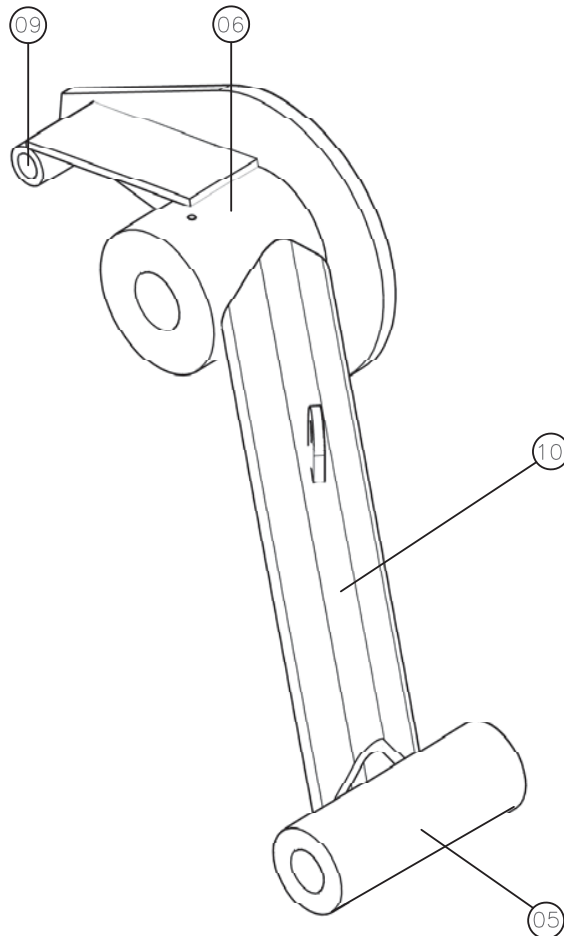

# OPERATION SECTION - COMPONENTS

## Main Adjustment Arm (06) Con't

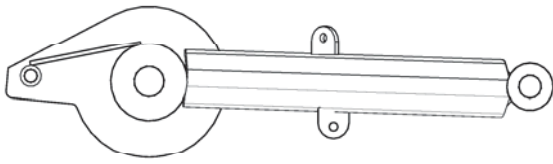

**(Front)**

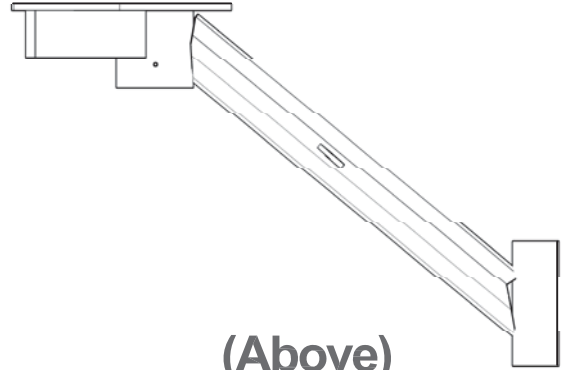

**(Above)**

**(Facing-Left)**

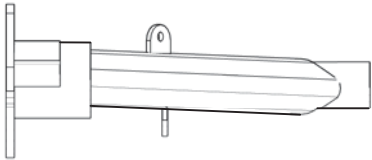

**(Facing-Right)**

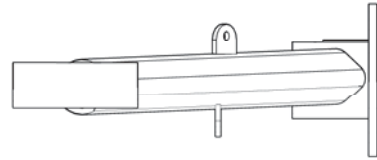

## OPERATION SECTION - COMPONENTS

### Turnbuckle (04)

The Turn Buckle (04) attaches to the Main Arm Support (10) once the PS has been locked into any of its positions. This allows the Main Adjustment arm to (06) to support the PS when in the vertical and extended positions.

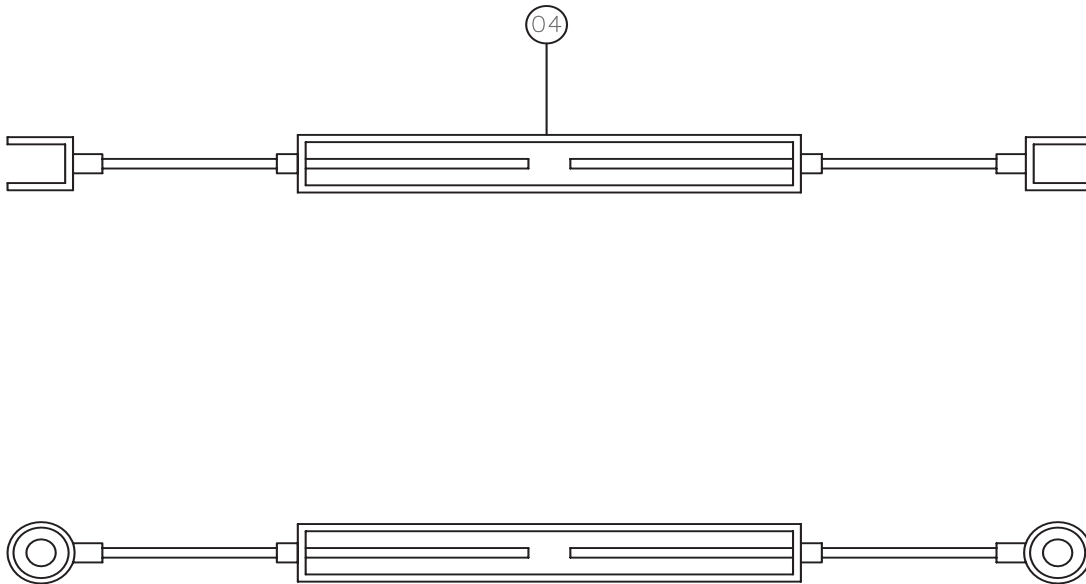

# OPERATION SECTION - COMPONENTS

## Motor (01)

The motor is the main component of the Path Slayer (PS). The 10 GPM Permco hydraulic motor is equipped with two SAE 7/8-14 ORB (O-Ring Boss) inlets. It is secured to the motor mount via four 5/8" x 2-1/2" socket caps with a 5/8" Toplock Nut (A) shown in figure 2. In order for the brush cutter to operate to full potential, the tractor must have a hydraulic flow rate of at least 9 GPM, optimal flow is 10 GPM. Hydraulics are linear, 10 GPM equals 100% of the optimal flow, 8 GPM equals 80% of the optimal flow and so on.

Figure 1



Figure 2

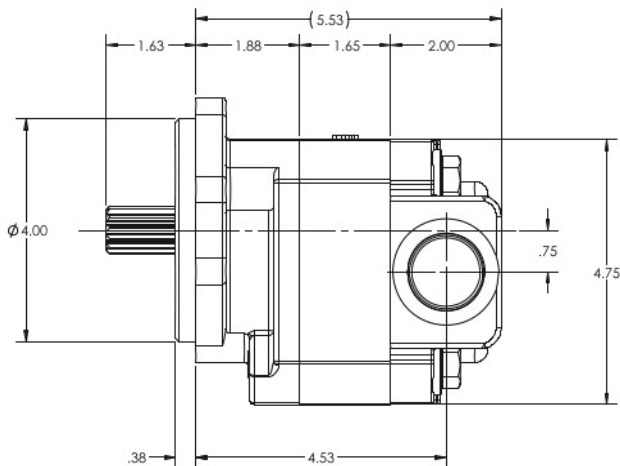
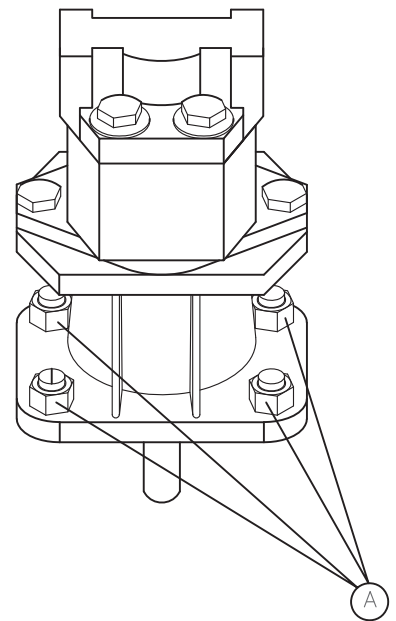

DRIVE SHAFT:  
SPLINED SAE B (13 TEETH)  
DP: 16/32 PRESSURE ANGLE: 30°  
ANSI B92.1-96

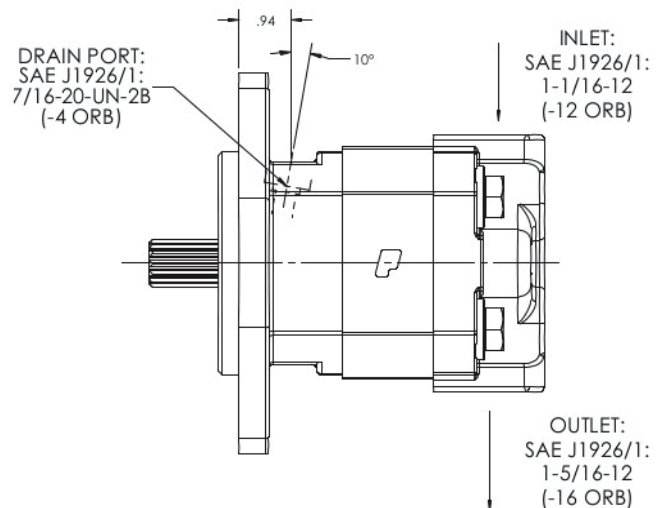

# OPERATION SECTION - COMPONENTS

## GEARBOX LUBRICATION

1. You must verify oil prior to using the unit.
2. Unscrew both of the two plugs at the top of the gearbox.
3. With a small funnel fill one of the openings with gear oil (E P85W-140). (Approximately 8oz.)
4. When you see the oil in the other opening you have filled the gearbox. Do not overfill.
5. Screw both of the plugs back in the threaded holes.
6. You are now ready to use the unit.



## Hydraulic Lines

The PathSlayer (PS) requires two hydraulic lines to operate. (NOT INCLUDED) One for pressure (02) and one for the return (03).



## OPERATION SECTION - COMPONENTS

### Hydraulic Hoses

To ensure your safety and that no harm is caused to you, the components of your PathSlayer, or your tractor it is **CRUCIAL** that the hydraulic line system is installed correctly. If you fail to follow these instructions **ANY** warranty on your PathSlayer will be voided. Follow these steps at all times while operating the PathSlayer. Failure to follow these instructions could result in serious injury or death.

### Plumbing

1. With the PathSlayer attached measure your tractor to determine approximate length of hoses. (Hose lengths will differ per tractor) To keep from reversing the hydraulic hoses, it is recommended that you use male and female quick disconnect fittings to attach the hydraulic hoses from your PathSlayer to the tractor. (Shown in Figure A)
2. To find the proper hydraulic hose length from the PathSlayer to your tractor you must position the PathSlayer in its offset position (see pg. 14 for position change instructions) and then angle the loader arm of the tractor to approximately -35 degrees. The length should be approximately 7-1/2 feet.
3. Attach pressure hose to one side of your tractors rear remotes.
4. Route the pressure hose along the tractor until you have reached the front of your tractors boom.
5. Route the return hose along the tractor until you have reached the front of your tractors boom.
6. Attach one pressure (02) and one return hose (03) onto your PathSlayer using the two Quick Connect inlets on the left side of your PathSlayer. (shown on Figure 1).
7. Attach the hydraulic hoses on your PathSlayer to the hydraulic hoses on the tractor using quick disconnect fittings. (Shown in Figure A).
8. Secure all hoses to tractor.
9. Once connected the air must be bled out of the hydraulic hoses. To do this you must briefly engage the hydraulics until the motor on the PathSlayer begins to rotate.
10. Check hydraulic fluid and fill to operating level per tractor specifications.

A

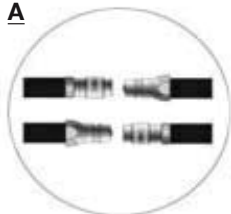

03

02

## OPERATION SECTION - COMPONENTS

### Blade Carrier (14)

The Blade Carrier (14) is a pan component roughly 23 inches long that attaches the Cutting Blades (17) to the spindle housing. This allows the Cutting Blades (17) to rotate freely around the spindle housing. 1 Cutting Blade (17) is mounted on each end of the Blade Carrier (14) giving the PS 44 inches of overall cutting width. The Deck Reinforcement (16) is located below the Cutting Deck (01), this keeps the Cutting Deck (01) structurally sound while in operation. The Deck Reinforcement Edge (15) is a 1/2 inch thick border that covers the front edge of the PS. This Deck Reinforcement Edge (15) protects the Cutting Deck (01) from any debris the PS may come in contact with while in operation.

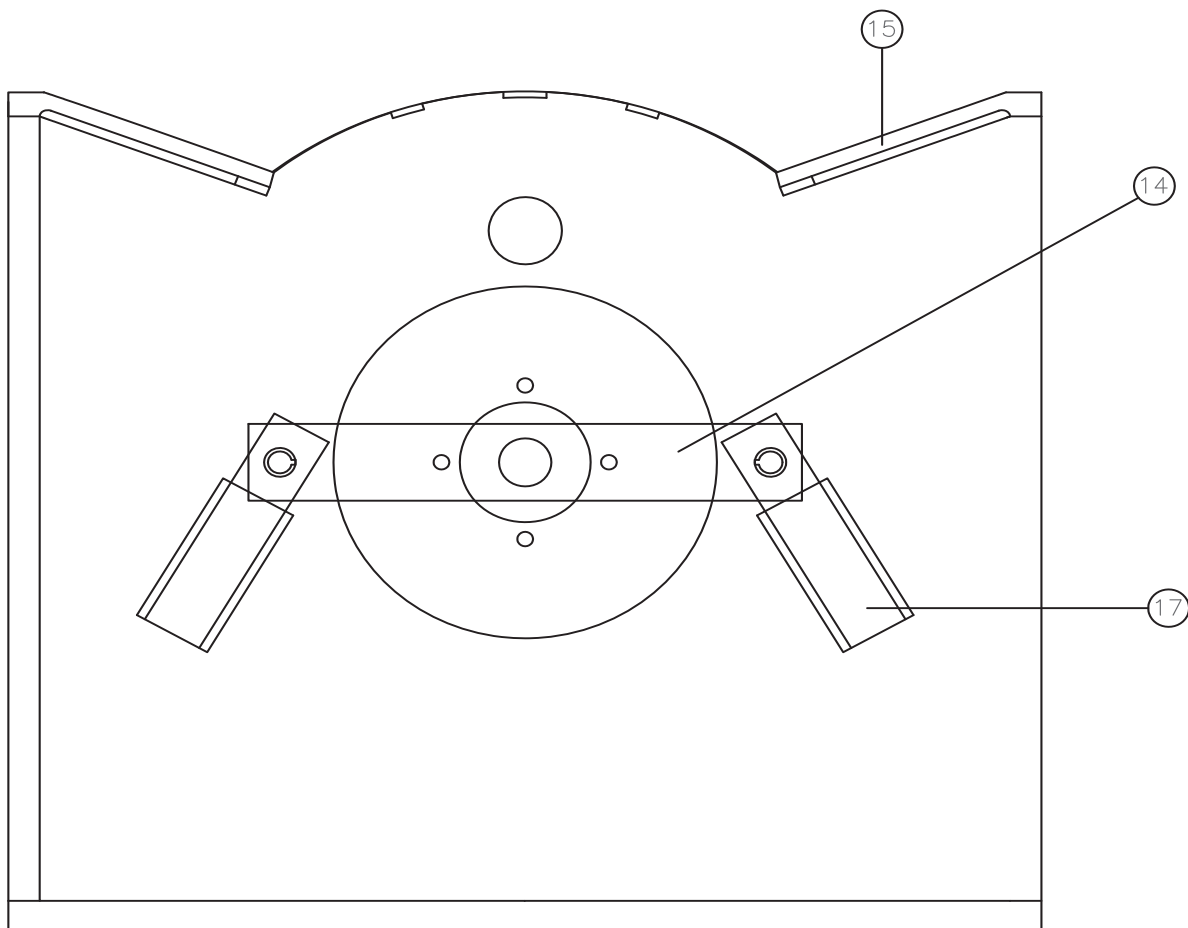

# **MAINTENANCE SECTION**

# MAINTENANCE SECTION

## General

Routine maintenance is key to the longevity of any implement. It is very important that you maintain your PathSlayer as described below.



### WARNING

To avoid serious injury or death make sure you follow these steps before attempting to service or repair the PathSlayer.

- Make sure tractor gear selector is in park or set parking brake.
- Make sure the engine is off.
- Make sure ignition key is removed.
- Make sure the tractor is parked on a level surface.
- Make sure all hydraulic hoses are disconnected from the PathSlayer.

## Daily

- Check for debris on deck of the PathSlayer.
- Check all hardware and tighten if necessary.
- Make sure all pins are in place and secure.
- Make sure the TurnBuckle is in place and secure.
- Check blades for damage and sharpness, replace if necessary. (If blades are in need of replacement, you **MUST** replace the mounting hardware as well.)
- Check blade mounting hardware.
- Check blade carrier hardware.
- Check hydraulic system for leaks.
- Make sure all safety and warning decals are present and legible.

## Blade Replacement

Before attempting to replace blades make sure you have completed all steps in the "WARNING" section of this page. Failure to complete these steps could result in serious injury or death. NEVER attempt to weld or straighten damaged blades.

1. Move the PathSlayer into the vertical position.
2. Lower the boom of the tractor until the PathSlayer is level and resting on the ground.
3. Remove bolt and top nut from each blade.
4. Replace blades.
5. Reinstall with **NEW** bolt, **NEW** flat washers, and **NEW** top lock nut on each blade.
6. Reinstall both hydraulic hoses.

## Every 40 Hours Operation

- Check for hose deterioration
- Check for weld deterioration
- Check for hydraulic motor wear

## MAINTENANCE SECTION

### Lubrication: Main Pivot Point

The main pivot point is where the main pivot arm attaches the deck of the PathSlayer to the mounting plate. This point allows all movement of the PathSlayer and must be properly maintained. To maintain the main pivot point it must always be properly greased before use. The main pivot point is located on the left side of the PathSlayer and is equipped with one grease fitting. It is recommended to check the main pivot point prior to every use. To check the main pivot point you need to rotate the main adjustment arm. If the main adjustment does not rotate with no resistance or feel loose then the pivot point needs to be greased.

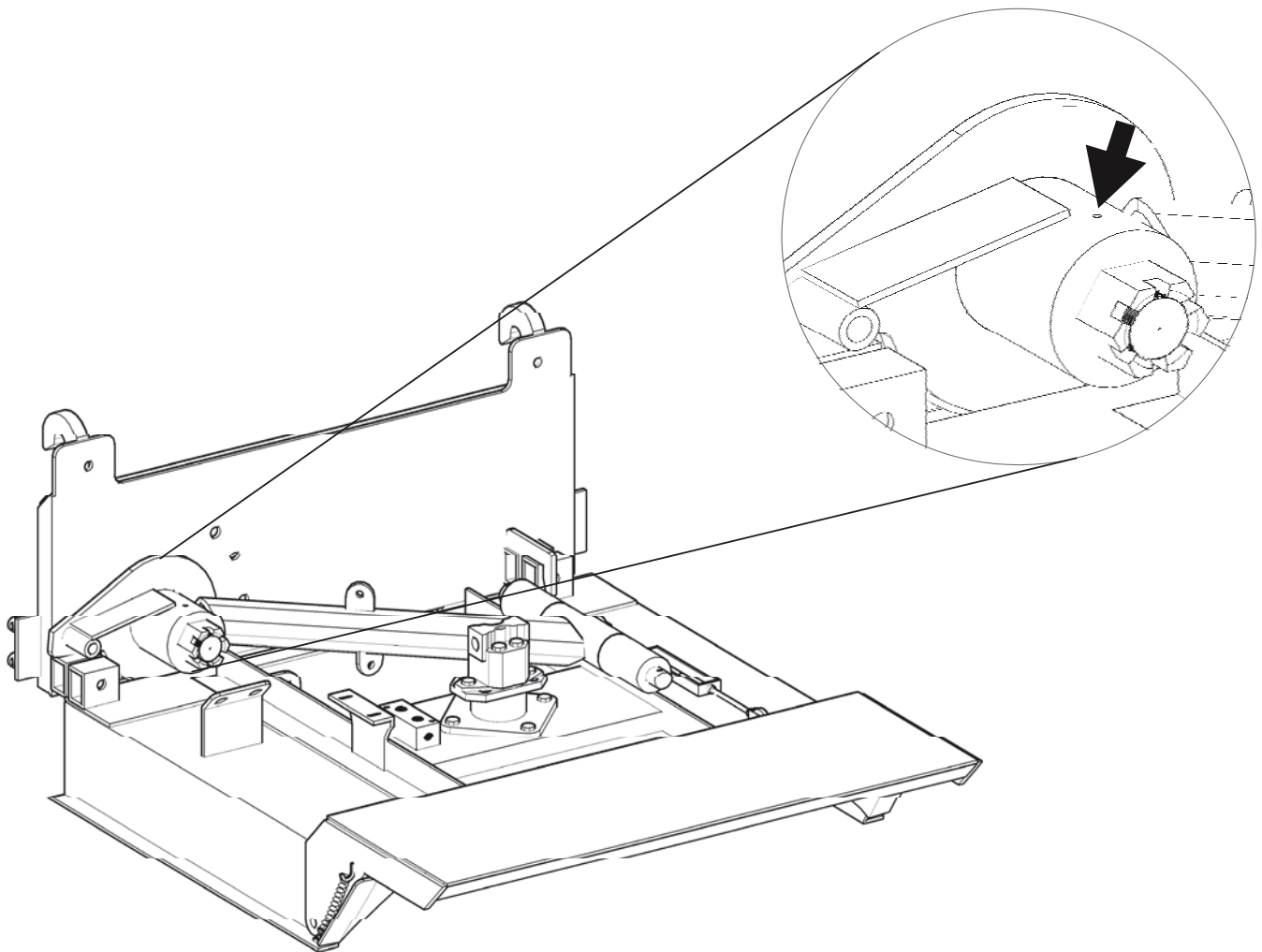

# MAINTENANCE SECTION

## **STORAGE**

### **Overview**

To keep your PathSlayer in its best condition, we recommend following the storage procedures listed below. It will also make sure your PathSlayer is off to a good start when needed. If your PathSlayer is going to be stored for long periods of time we **STRONGLY** recommend following these procedures to increase the life of your PathSlayer.

### **Preparing Unit For Storage**

1. Complete daily checklist.
2. Clean all mud, dirt, and debris from the PathSlayer.
3. Tighten any loose hardware.
4. Replace any safety/warning decals if damaged or illegible.
5. Touch up any chipped or scratched areas.
6. Connect hydraulic lines into each other.
7. Store the unit in a dry area.

### **Removing from Storage**

1. Remove any protective coverings installed.
2. Complete daily checklist.
3. Check all hardware, tighten if necessary.
4. Check hydraulic hoses for deterioration.

*Proper storage position shown below.*

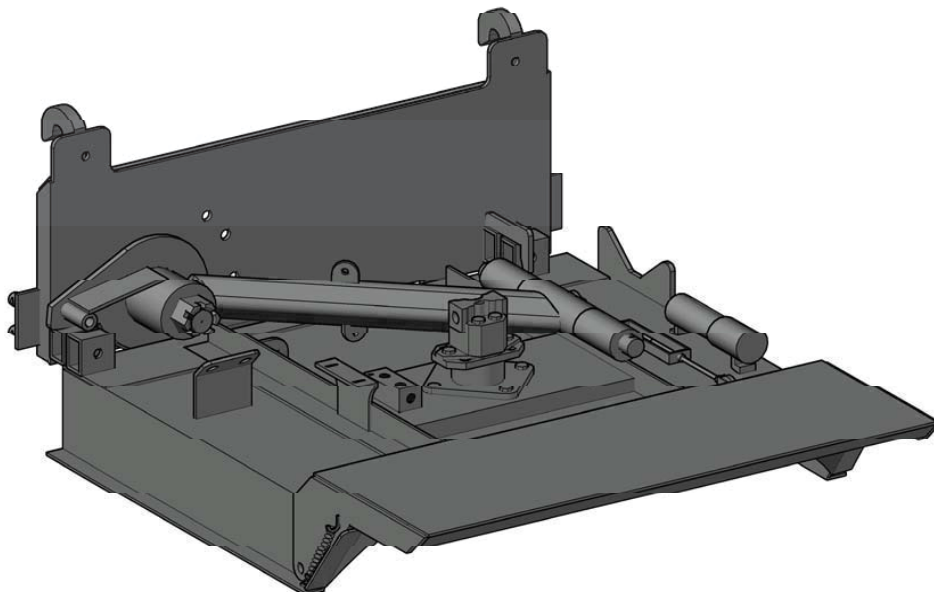

# **ASSEMBLY/PARTS SECTION**

## ASSEMBLY/PARTS SECTION

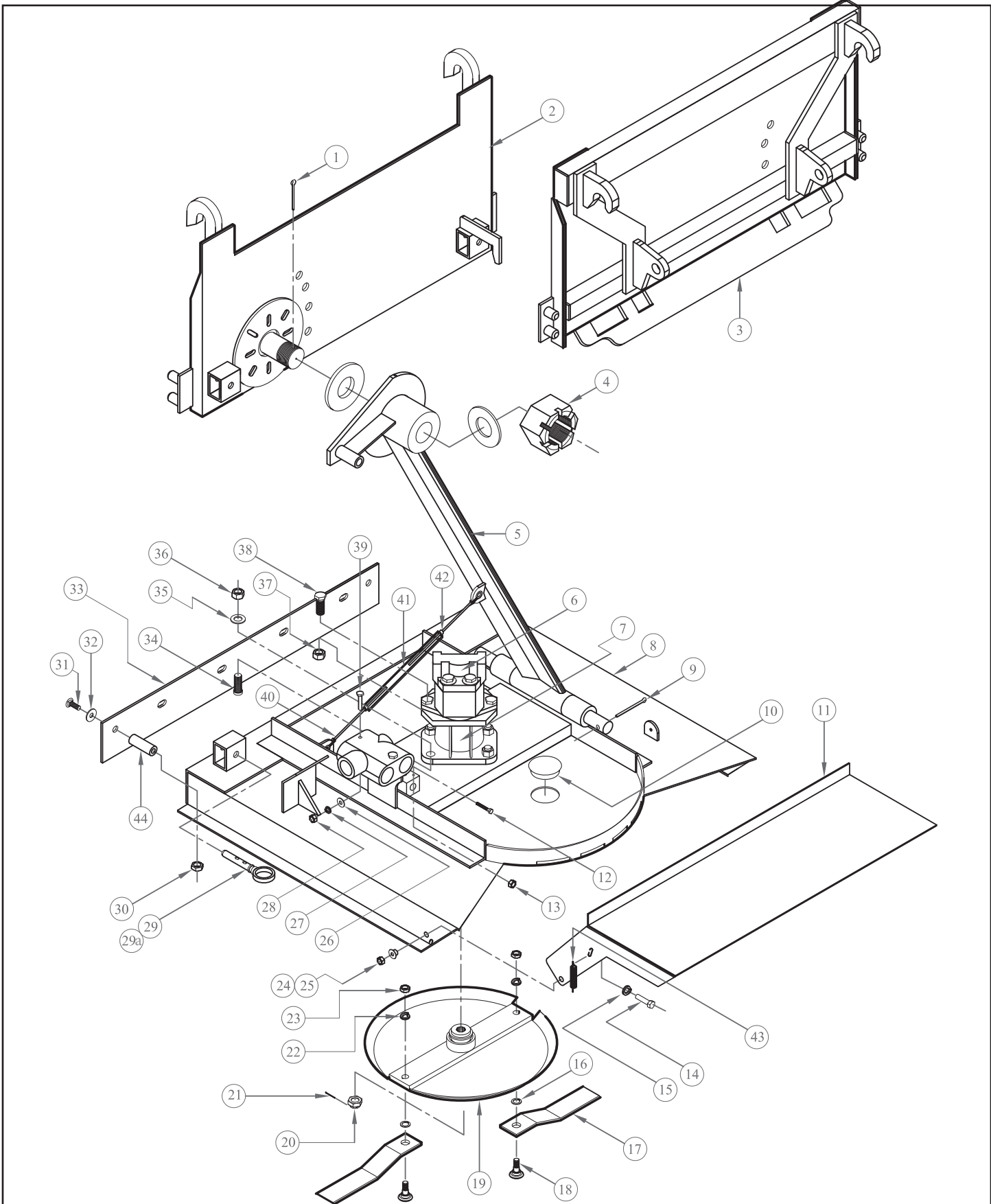

## ASSEMBLY/PARTS SECTION

ITEM	PART NO.	QUANTITY	DESCRIPTION
1.....	647-2505.....	1.....	1/4" x 5 Cotter Pin
2.....	401-PSMountplate.....	1.....	PS Mount Plate
3.....	401-PSMountplateEH.....	1.....	PS Mount Plate Euro Hitch
4.....	900-8883.....	1.....	3" Slotted Nut
5.....	401-PSMAST.....	1.....	Master
6.....	711-3402.....	1.....	Hyd. Pump
7.....	401-0179.....	1.....	Skid Steer Bottom Gear Box
8.....	401-PSDeckwip.....	1.....	Path Slayer Deck
9.....	412-0081.....	2.....	Cotter Pin 3/8"x3-1/2"
10.....	116-1656.....	1.....	3" Rd. Caplug
11.....	401-PSShield.....	1.....	Shield Weldment
12.....	400-0018.....	2.....	5/16" x 3" Gr. 8 Bolt
13.....	412-628-5.....	2.....	5/16" Nylock Nut
14.....	412-2085.....	2.....	1/2 x 2-1/2 Bolt
15.....	412-0072-01.....	2.....	1/2 Flatwasher
16.....	830-1018NH.....	2.....	Notched Washer,Hardener
17.....	401-0154.....	2.....	Blade
18.....	412-0057-01.....	2.....	Blade Bolt
19.....	401-PSBB.....	1.....	Blade Carrier
20.....	501-0266.....	1.....	Hex Nut 1" Castl.
21.....	647-100.....	1.....	5/32" x 2" Cotter Pin
22.....	900-8771.....	2.....	Lock Wash
23.....	125-925.....	2.....	Jam Nut
24.....	412-3243.....	2.....	1/2" Nylock Nut
25.....	105-4435.....	2.....	Guard Bushing
26.....	638-4.....	2.....	1/4" Flat Washer
27.....	636-4.....	2.....	1/4" Lock Washer
28.....	412-0082.....	2.....	1/4" Hex Nut
29.....	401-PSLongpin.....	1.....	Long Pin
29a.....	154-5.....	1.....	Hitch Pin
30.....	412-0058.....	4.....	1/2" Hex Nuts
31.....	412-0042-02.....	4.....	1/2" x 1-1/2" Bolt Gr. 5
32.....	412-0072-01.....	4.....	1/2" Flat Washer
33.....	104-0044.....	1.....	Rear Rubber Guard
34.....	412-0024.....	4.....	5/8" x 2-1/2 Gr. 8 Bolt
35.....	412-0076-01.....	4.....	5/8" Gr. 8 Flat Washer
36.....	412-3500.....	4.....	5/8" Toplock Nut
37.....	412-2006.....	2.....	9/16" Top lock
38.....	412-2007.....	2.....	9/16" x 2-1/2" Gr. 8 Bolt
39.....	605-415.....	2.....	Hex Cap Screw
40.....	405-3016.....	1.....	Galv. Nut 5/8" RH
41.....	651-5812.....	1.....	Turn Buckle
42.....	412-0059-01.....	1.....	Hex Nut 5/8"-11 LH Thread Galv
43.....	104-0045.....	2.....	Extension Spring

ASSEMBLY/PARTS SECTION

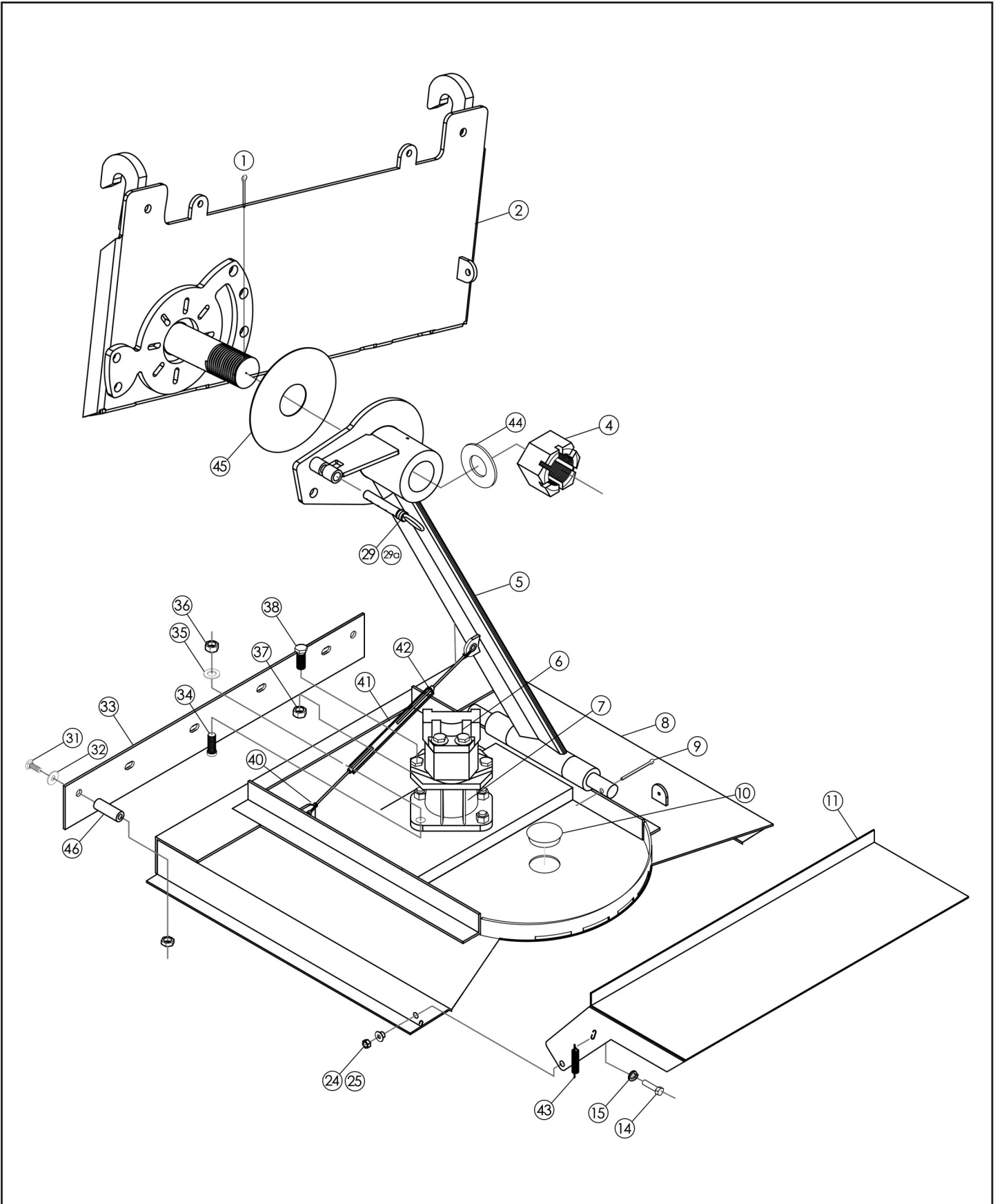

## ASSEMBLY/PARTS SECTION

ITEM	PART NO.	QUANTITY	DESCRIPTION
1.....	647-2505 .....	1 .....	1/4" x 5 Cotter Pin
2.....	401-PSMountplate-2 .....	1 .....	PS Mount Plate
4.....	900-8883.....	1 .....	3" Slotted Nut
5.....	401-PSMASTHD-2.....	1 .....	Master
6.....	711-3402.....	1 .....	Hyd. Pump
7.....	401-0179.....	1 .....	Skid Steer Bottom Gear Box
8.....	401-PSDeckwip.....	1 .....	Path Slayer Deck
9.....	412-0081.....	2 .....	Cotter Pin 3/8"x3-1/2"
10.....	116-1656.....	1 .....	3" Rd. Caplug
11.....	401-PSShield.....	1 .....	Shield Weldment
14.....	412-2085.....	2 .....	1/2 x 2-1/2 Bolt
15.....	412-0072-01.....	2 .....	1/2 Flatwasher
24.....	412-3243.....	2 .....	1/2" Nylock Nut
25.....	105-4435.....	2 .....	Guard Bushing
29.....	401-PSLongpin.....	1 .....	Long Pin
29a.....	154-5 .....	1 .....	Hitch Pin
30.....	412-0058.....	4 .....	1/2" Hex Nuts
31.....	412-0042-02.....	4 .....	1/2" x 1-1/2" Bolt Gr. 5
32.....	412-0072-01.....	4 .....	1/2" Flat Washer
33.....	104-0044.....	1 .....	Rear Rubber Guard
34.....	412-0024.....	4 .....	5/8" x 2-1/2 Gr. 8 Bolt
35.....	412-0076-01.....	4 .....	5/8" Gr. 8 Flat Washer
36.....	412-3500.....	4 .....	5/8" Toplock Nut
37.....	412-2006.....	2 .....	9/16" Top lock
38.....	412-2007.....	2 .....	9/16" x 2-1/2" Gr. 8 Bolt
40.....	405-3016.....	1 .....	Galv. Nut 5/8" RH
41.....	651-5812.....	1 .....	Turn Buckle
42.....	412-0059-01.....	1 .....	Hex Nut 5/8"-11 LH Thread Galv
43.....	104-0045.....	2 .....	Extension Spring
44.....	104-0048.....	1 .....	Small Plastic Washer
45.....	104-0047.....	1 .....	Big Plastic Washer
46.....	105-4434.....	2 .....	Rubber Guard Bushing

# ASSEMBLY/PARTS SECTION

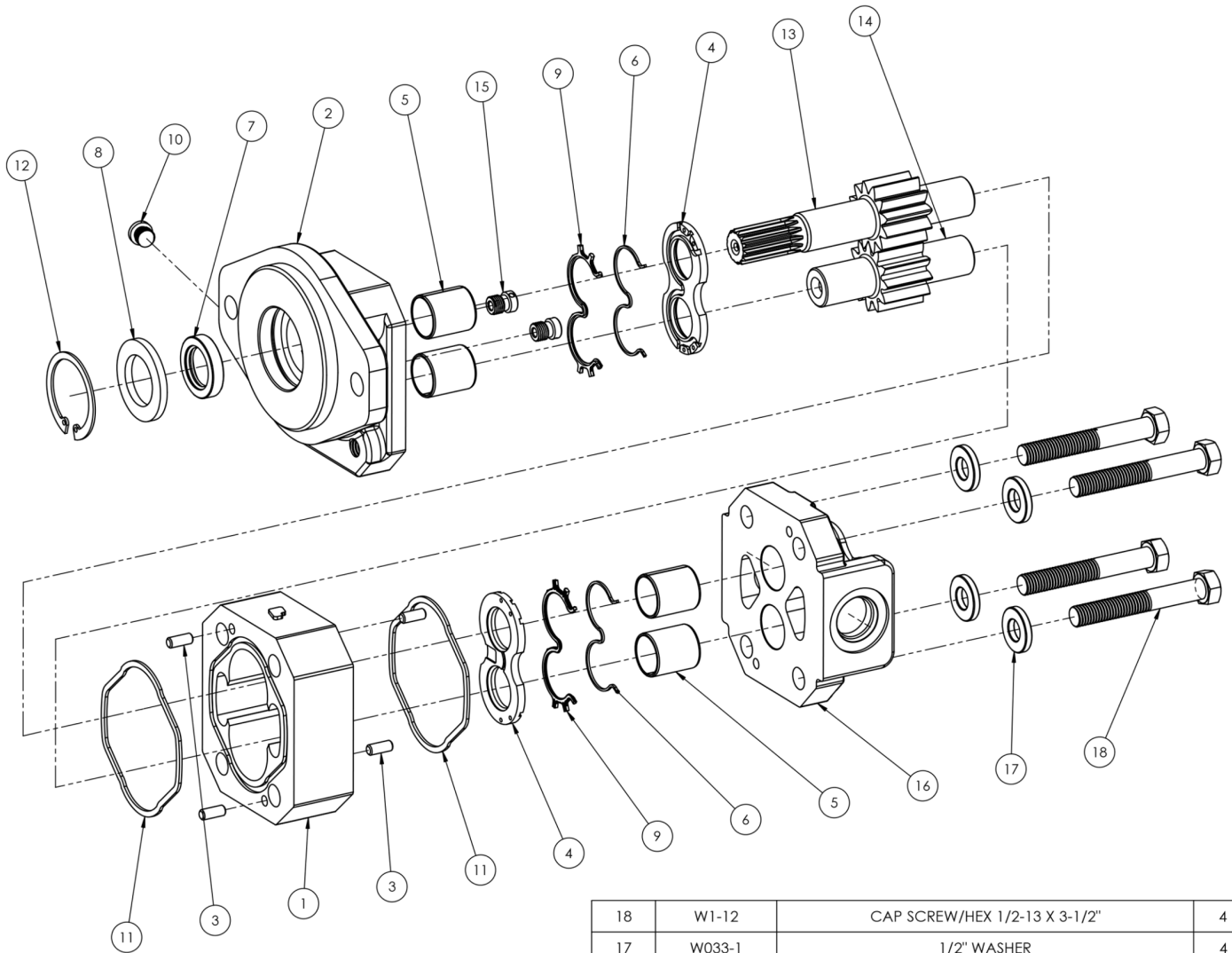

18	W1-12	CAP SCREW/HEX 1/2-13 X 3-1/2"	4
17	W033-1	1/2" WASHER	4
16	592-01195	124 PEC, MOTOR, SINGLE *3/4" ORB LEFT X 1" ORB RIGHT SIDE PORTS INSTALL C CW	1
15	L-0280-K	2500,3700,3000,5000,7500CK	2
14	996-01103-12ID	124 IDLER GEAR, 1 1/4"	1
13	024-01104-12DR	124 G/SH,T2,B SPLN,TNDM,1-1/4"	1
12	565-00407-ISR	124/5151/3000 SERIES SNAP RING	1
11	TA-2995-153	124 SQUARE GASKET SEAL, MOTOR	2
10	565-01194	PLUG,STEEL,ORB,HOLLOW HEX,-4	1
9	947-01107	124 THRUST PLATE SEAL, PUMP	2
8	961-01193	124 SHAFT SEAL RETAINER, MOTOR	1
7	249-01555	124 SHAFT SEAL, DOUBLE LIP,MTR	1
6	947-01106	124 TP BACK-UP (ZYTEL), PUMP *INSTALL FOR C CW PUMP ROTATION	2
5	921-01108	124 BUSHING	4
4	947-01105	124 THRUST PLATE, PUMP	2
3	280-1971-071	124 DOWEL PIN	4
2	574-01191	124 SEC, T2, 2 BOLT B, MOTOR	1
1	577-01158-12	124 GEAR HOUSING,MOTOR, 1-1/4"	1
<b>Item #</b>	<b>Part #</b>	<b>Description</b>	<b>Qty.</b>

## ASSEMBLY/PARTS SECTION



ITEM	PART NO.	QUANTITY	DESCRIPTION
1.	227-5053	1	1/2" CPLR FM Pipe
2.	227-5054	1	1/2" NPLE FM Pipe
3.	800-PS8837	1	Straight Adapter, 1/2" Male
4.	800-PS02	1	10.5 Hard Tube
5.	800-PS2577	1	Elbow 90° 1/2" Male JIC
6.	800-PS2608	2	Elbow 90° 1/2" Male Pipe
7.	401-PS20	1	PS HYD Hose 20"
8.	800-PS6735	1	PS Outlet Connect
9.	800-PS8890	1	PS Inlet Connector
10.	401-PS16	1	PS Hyd Hose 16"
11.	105-4409	1	Manifold
12.	800-PS01	1	PS 12.625 Hard Tube
13.	401-PS24	1	PS Hyd Hose 24"
14.	262-1510	1	Hyd. Flow Regulator
15.	401-PS16-01	1	PS Hyd Hose 16" Main

# ASSEMBLY/PARTS SECTION

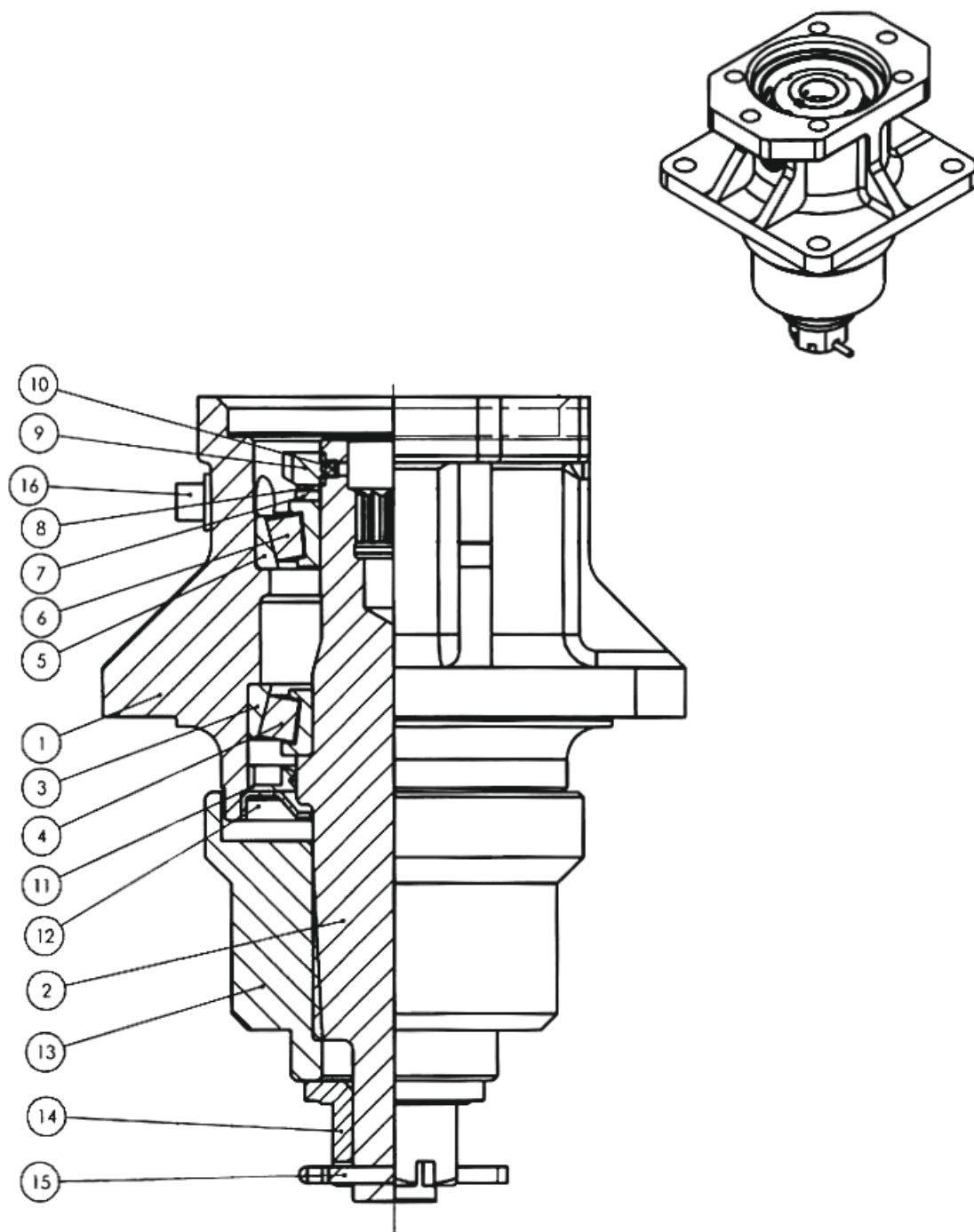

## ASSEMBLY/PARTS SECTION

### 401-0179 Gearbox MDH-40 Parts List

Item	Part Number	Description	Qty
1.....		HOUSING, MDH-40 .....	1
2.....	MDH40-040778.....	SHAFT-13Z INPUT SPLINE-11 .....	1
3.....	MDH40-050200.....	BEARING, CUP 30210Y .....	1
4.....	MDH40-050201.....	BEARING, CONE 30210X.....	1
5.....	MDH40-050239.....	BEARING, CUP 30209Y .....	1
6.....	MDH40-050240.....	BEARING, CONE 30209X.....	1
7.....	MDH40-090464.....	WASHER WITH TANG .....	1
8.....	MDH40-130099.....	LOCK WASHER, M45 .....	1
9.....	MDH40-120136.....	LOCKNUT, M45 X 1.5 BEARING .....	1
10.....	MDH40-110304.....	SET SCREW, M5 .....	2
11.....	MDH40-060183.....	LIP SEAL-OUTPUT .....	1
12.....	MDH40-240567.....	SEAL PROTECTOR .....	1
13.....	MDH40-210034.....	BLADE HUB 15T .....	1
14.....	MDH40-120050.....	NUT, HEX SLOTTED, 1-14UNS .....	1
15.....	MDH40-100001.....	COTTER PIN 5MM X 50MM.....	1
16.....	MDH40-140023.....	PLUG, PIPE SQUARE HEAD, 3/8" -18NPT .....	2

# ASSEMBLY/PARTS SECTION

## PATHSLAYER BLADE CARRIER ASSEMBLY

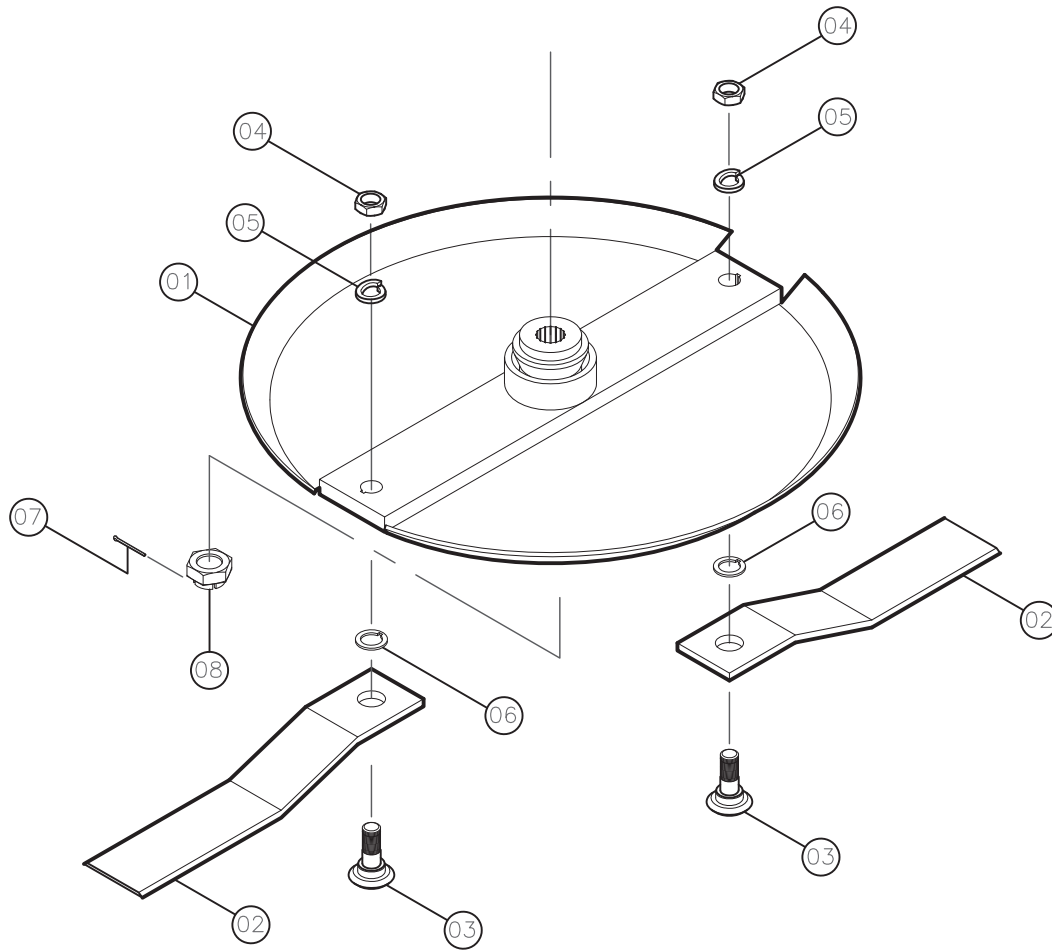

NO.	PART NUMBER	QTY.	DESCRIPTION
01.....	401-PSBB .....	1 .....	BLADE BAR ASSEMBLY
02.....	401-0154 .....	2 .....	BLADE, PathSlayer DBL EDGE
03.....	412-0057-01 .....	2 .....	BLADE BOLT BB70 1-1/8 W/ 1/2 SHLD
04.....	125-925.....	2 .....	JAM NUT 1-1/8" GR 8
05.....	900-8771.....	2 .....	LOCKWASHER 1-1/8
06.....	830-1018NH .....	2 .....	WASHER W/ KEYWAY, HARDENED
XX.....	412-8043-03 .....	2 .....	BLADE BOLT KIT (3, 4, 5, 6)
07.....	647-100 .....	1 .....	5/32" x 2" COTTER PIN
08.....	501-0266 .....	1 .....	FLANGE NUT

# ASSEMBLY/PARTS SECTION - COMPACT PATHSLAYER

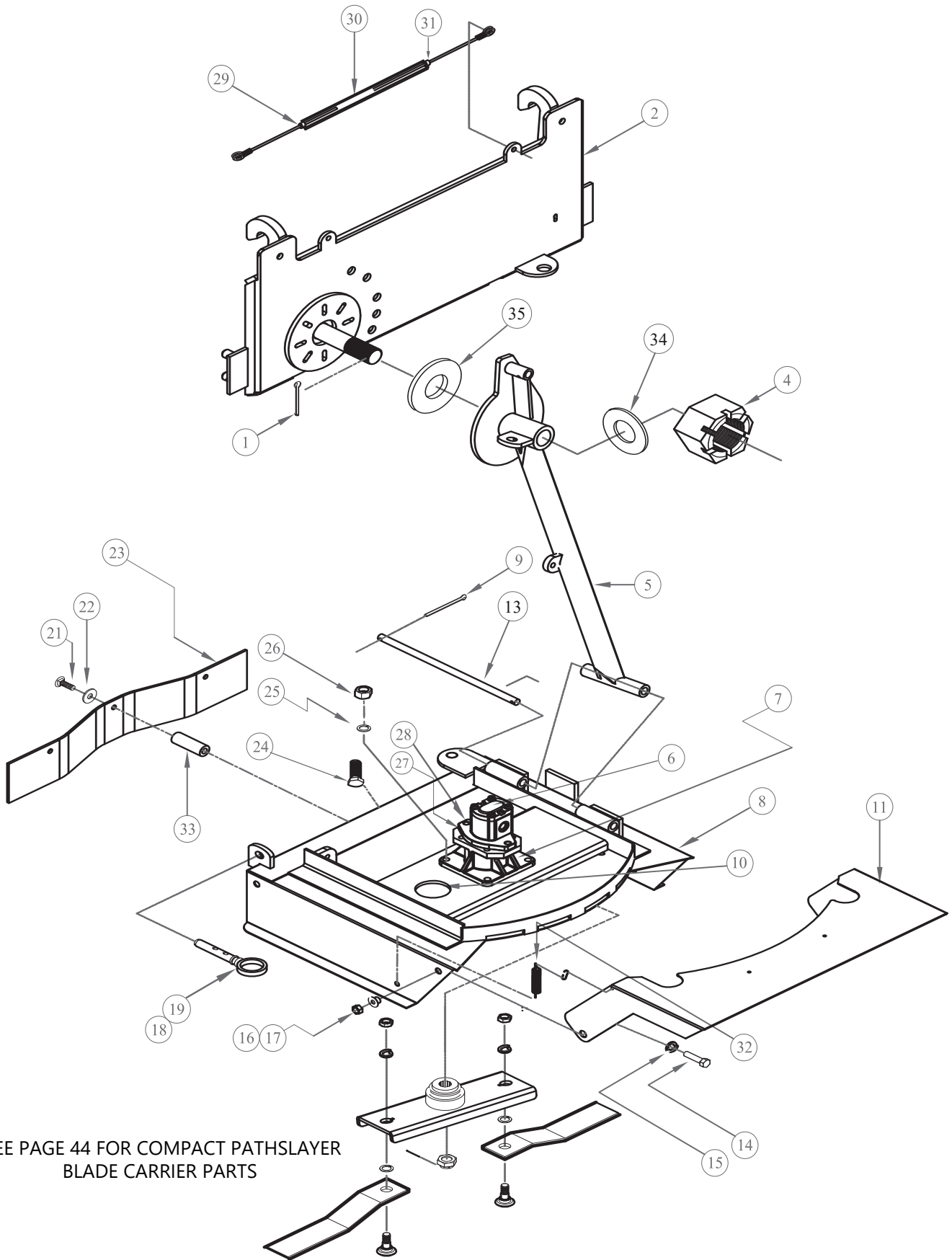

SEE PAGE 44 FOR COMPACT PATHSLAYER  
BLADE CARRIER PARTS

## ASSEMBLY/PARTS SECTION - COMPACT PATHSLAYER

ITEM	PART NO.	QUANTITY	DESCRIPTION
1.....	647-2505.....	1.....	1/4" x 5 Cotter Pin
2.....	401-CPSMOUNTPLATE.....	1.....	CPS Mount Plate
4.....	900-8884.....	1.....	2" Slotted Nut
5.....	401-CPSMASTWIP.....	1.....	CPS Mast Weldment
6.....	711-3402.....	1.....	Hyd. Pump
7.....	401-0179.....	1.....	Skid Steer Bottom Gear Box
8.....	401-CPSDECKWIP.....	1.....	Compact Path Slayer Deck
9.....	412-0081.....	2.....	Cotter Pin 3/8"x3-1/2"
10.....	116-1656.....	1.....	3" Rd. Caplug
11.....	401-CPSSHIELDWIP.....	1.....	CPS Shield Weldment
13.....	105-4445.....	1.....	CPS HINGE ROD
14.....	412-2085.....	2.....	1/2 x 2-1/2 Bolt
15.....	412-0072-01.....	2.....	1/2 Flatwasher
16.....	412-3243.....	2.....	1/2" NYLOCK NUT
17.....	105-4435.....	2.....	PS GUARD STEP DOWN BUSHING
18.....	401-PSLONGPIN.....	2.....	PS LONG PIN
19.....	154-5.....	2.....	HITCH PIN CLIP
21.....	412-0042-02.....	2.....	BOLT, 1/2 X 1-12
22.....	412-0072-01.....	3.....	FLAT WASHER 1/2"
23.....	104-0044.....	1.....	REAR RUBBER GUARD CPS
24.....	412-0024.....	2.....	BOLT 5/8 X 2-1/2
25.....	412-0076-01.....	6.....	F/W 5/8"
26.....	412-3500.....	4.....	TOP LOCK NUT 5/8-18
27.....	412-2006.....	2.....	TOP LOCK NUT 9/16
28.....	412-2007.....	2.....	BOLT 9/16" X 2-1/2"
29.....	405-3016.....	1.....	NUT 5/8"
30.....	651-5812.....	1.....	TURNBUCKLE 5/8 X 12
31.....	412-0059-01.....	1.....	HEX NUT, 5/8 - 11
32.....	104-0045.....	2.....	PS EXT SPRING 3/4
33.....	105-4434.....	1.....	PS Rubber Guard Bushing
34.....	105-4439.....	1.....	CPS SML PLASTIC WASHER
35.....	105-4440.....	1.....	CPS LG PLASTIC WASHER

# ASSEMBLY/PARTS SECTION - COMPACT PATHSLAYER

## COMPACT PATHSLAYER BLADE CARRIER

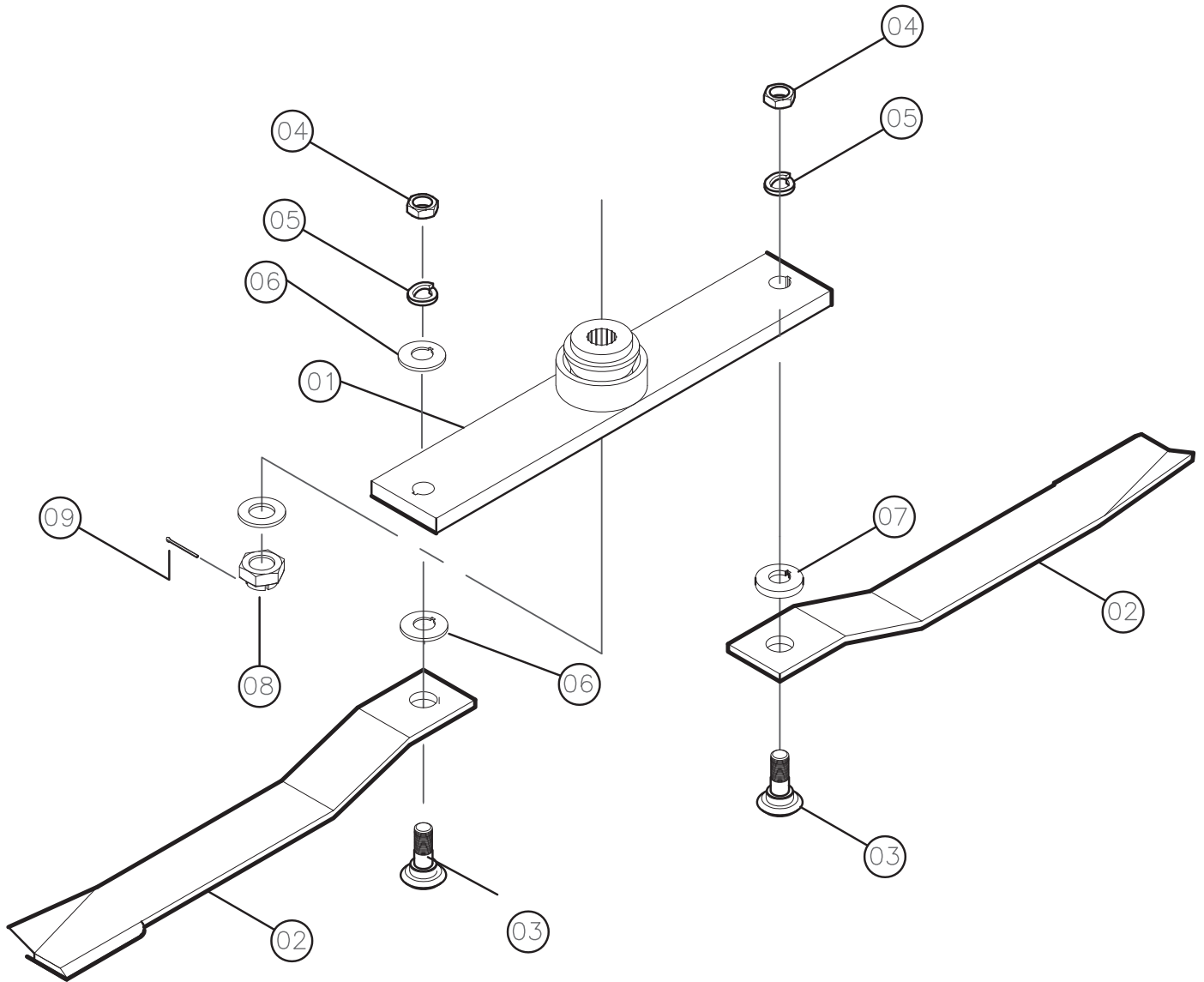

NO.	PART NUMBER	QTY.	DESCRIPTION
01	401-CPSBB	1	BLADE BAR ASSEMBLY
02	401-0153A	2	BLADE
03	412-0057-03	2	BLADE BOLT
04	125-925	2	NUT
05	900-8771	2	FLATWASHERS
06	610-1270	2	1/4" WEAR PAD
07	610-1270-1	1	1/2" WEAR PAD
08	647-100	1	5/32" x 2" COTTER PIN
09	501-0266	1	Hex Nut 1" Castle
XX	412-8043-03	2	BLADE BOLT KIT (3, 4, 5, 6)

# MODERN AG PRODUCTS, LTD. WARRANTY INFORMATION

## **A. Limited Warranties**

Modern Ag warrants any new Modern Ag implement purchased from an authorized Modern Ag dealer to the purchaser for a period not to exceed one (1) year from original purchase date, to be free from defects in material and workmanship. Warranty services must be performed by a dealer or service center authorized by Modern Ag using only new or remanufactured parts or components furnished by Modern Ag. Modern Ag reserves the right to inspect all parts which are claimed to have been defective in material and workmanship. Modern Ag makes no warranty as to the design, capability, capacity or suitability for the use of the implement.

## **B. Limited Warranty Service**

To receive warranty service, the Purchaser must return the Registration & Warranty Card along with Checklist to Modern Ag within 30 days of original purchase. Purchaser must report claim, in writing, to the authorized Modern Ag dealer from whom the Purchaser purchased the implement originally or an approved Modern Ag dealer within 30 days after the Purchaser discovers the circumstance for the basis of the claim. The purchaser will be responsible for any service call and/or the return to and from the dealer's or service center's place of business.

## **C. Not Covered by Warranty**

The limited warranty does not cover any goods or part(s) that have been subjected to improper or abnormal use such as negligence, abuse, alteration, modification, accident, lack of or improper maintenance, use of wrong oil or lubricants. This limited warranty does not apply to expendable items such as blades, shields, guards, pneumatic tires or any normal maintenance parts or service. Also not covered is wear items such as teeth, chains, sprockets, belts, springs, gearbox lubricant, hydraulic fluid or any other items that in the company's sole judgment is a wear item.

## **D. Disclaimer of Implied Warranties & Consequential Damages**

Except as provided herein, no employee, agent, Dealer, or other person is authorized to give any warranties of any nature on behalf of Modern Ag. The purchaser's only remedies in connection with the breach or performance of any warranty on the Modern Ag implements are those set forth on this page. In no event will Modern Ag, the dealer or any company affiliated with Modern Ag be liable for incidental or consequential damages. Such incidental and consequential damages shall include but not be limited to transportation charges other than normal freight charges, cost of installation other than cost approved by Modern Ag, duty, taxes, charges for normal service or loss of crops or any other loss of income, rental of substitute equipment, expenses due to loss, damage, detention or delay in the delivery of equipment or parts resulting from acts beyond Modern Ag's control. Except as provided herein, no employee, agent, Dealer, or other person is authorized to give any warranties of any nature on behalf of Modern Ag.

**This form is required to be mailed with the completed Warranty Registration to  
PO Box 790, Beaumont, TX 77704**

# MODERN AG PRODUCTS, LTD. WARRANTY INFORMATION

**DEALER:** I hereby certify that:

1. The machine has been correctly assembled in accordance with manufacturer's instructions.
2. All bolts have been checked and tightened.
3. All other pre-delivery checks have been completed as per operator's manual.
4. Purchaser was given operators manual and instructed in safe and correct usage of machine and on limitation of warranty.
5. Machine was tested and operates correctly.

**PURCHASER:** I hereby certify that:

1. The machine is correctly assembled.
2. Receipt of the operator's manual which I have read and clearly understood.
3. I have a clear understanding of the warranty limitations.
4. I have a clear understanding on the correct and safe operation of the machine.
5. That the machine needs regular maintenance as per instructions in operator's manual.
6. I have a clear understanding on the capacity of this machine and am aware of its limitations.

MODEL \_\_\_\_\_ SERIAL # \_\_\_\_\_

DEALER \_\_\_\_\_ DATE DELIVERED \_\_\_\_\_

DEALER'S STAMP

PURCHASERS' ADDRESS:

To register your implement and be eligible for warranty service, mail the completed Warranty Registration & Checklist to

**PO Box 790, Beaumont, TX 77704**

If you have any questions, please contact [wholegoods.warranty@modernusa.com](mailto:wholegoods.warranty@modernusa.com)

2402v1

# MODERN AG PRODUCTS, LTD. WARRANTY INFORMATION

## MODERN AG PRODUCTS, LTD. PATHSLAYER CHECKLIST

### **Dealer:**

Tractor Model: \_\_\_\_\_ Tractor HP: \_\_\_\_\_ Tractor GPM Rating: \_\_\_\_\_

Tractor Hydraulic Reservoir Capacity: \_\_\_\_\_ Does the tractor have a 3<sup>rd</sup> Function? \_\_\_\_\_

Tractor has an HST transmission? \_\_\_\_\_ HR30 required? \_\_\_\_\_

Rear remote has a detent valve, not a float valve? \_\_\_\_\_ Intended Hours of Operation? \_\_\_\_\_

\_\_\_\_\_ I have given the Purchaser an operating manual and reviewed operating procedures with them.

\_\_\_\_\_ To the best of my knowledge, the Purchaser's tractor (as listed above) is suitable for operating the attachment.

### **Purchaser:**

Tractor Model: \_\_\_\_\_ Tractor HP: \_\_\_\_\_ Tractor GPM Rating: \_\_\_\_\_

Tractor Hydraulic Reservoir Capacity: \_\_\_\_\_ I [ do / do not ] require an HR30 for proper operation.

\_\_\_\_\_ I understand that I need to have a counterweight implement or HR30 on the back of the tractor during operation.

\_\_\_\_\_ I have been given an operating manual from the Dealer and understand proper operating procedures.

\_\_\_\_\_ I understand that the Dealer has deemed only the tractor listed above as suitable for operation, and if I operate the attachment with a different tractor, I am doing so at my own risk and liability.

### **Dealer and Purchaser:** Please initial each line ensuring following information has been reviewed:

\_\_\_\_\_ Minimum HP Ratings: 50 HP for PathSlayer, 25 HP for Compact PathSlayer

\_\_\_\_\_ Minimum 8-gallon hydraulic reservoir required, otherwise an HR30 is required.

\_\_\_\_\_ The HR30 is recommend for best operation but will function with rear remote or 3rd function if equipped properly (see dealer for requirements)

\_\_\_\_\_ If operating with a third function, intermediate/occasional use is best to avoid hydraulic oil overheating.

\_\_\_\_\_ This unit requires half inch hoses.

\_\_\_\_\_ The Purchaser has been given and has read/understands operating procedures or has watched a video detailing operating procedures.

I certify that all the above information is correct. I understand that failure to comply with the above standards waives any liability of Modern Ag. I understand that failure to report accurate or new information also waives any liability of Modern Ag.

Dealer Signature: \_\_\_\_\_ Purchaser signature: \_\_\_\_\_

**This form is required to be mailed with the completed Warranty Registration to  
PO Box 790, Beaumont, TX 77704**

**If you have any questions, please contact [wholegoods.warranty@modernusa.com](mailto:wholegoods.warranty@modernusa.com)**